

# Nokia Speakerphone HF-200

---

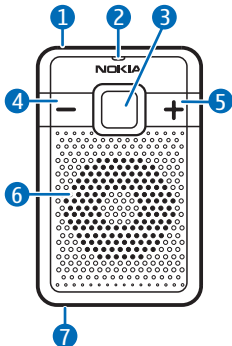

9207894/1

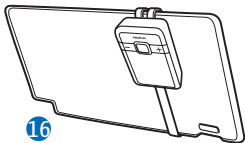
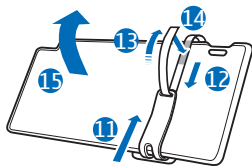
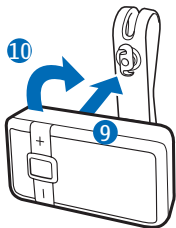

**DECLARATION OF CONFORMITY**

Hereby, NOKIA CORPORATION declares that this HF-36W product is in compliance with the essential requirements and other relevant provisions of Directive 1999/5/EC. The product is in conformity with the limits defined in Directive 2004/104/EC (amending Directive 72/245/EEC), Annex I, paragraph 6.5, 6.6, 6.8 and 6.9. A copy of the Declaration of Conformity can be found at [http://www.nokia.com/phones/declaration\\_of\\_conformity](http://www.nokia.com/phones/declaration_of_conformity)

**CE 0560**

© 2008 Nokia. All rights reserved.

Nokia and Nokia Connecting People are registered trademarks of Nokia Corporation. Other product and company names mentioned herein may be trademarks or tradenames of their respective owners.

Reproduction, transfer, distribution, or storage of part or all of the contents in this document in any form without the prior written permission of Nokia is prohibited.

Bluetooth is a registered trademark of Bluetooth SIG, Inc.

Nokia operates a policy of ongoing development. Nokia reserves the right to make changes and improvements to any of the products described in this document without prior notice.

To the maximum extent permitted by applicable law, under no circumstances shall Nokia or any of its licensors be responsible for any loss of data or income or any special, incidental, consequential or indirect damages howsoever caused.

The contents of this document are provided "as is". Except as required by applicable law, no warranties of any kind, either express or implied, including, but not limited to, the implied warranties of merchantability and fitness for a particular purpose, are made in relation to the accuracy, reliability or contents of this document. Nokia reserves the right to revise this document or withdraw it at any time without prior notice. The availability of particular products may vary by region. Please check with your Nokia dealer for details.

### Export controls

This device may contain commodities, technology or software subject to export

laws and regulations from the US and other countries. Diversion contrary to law is prohibited.

## For your safety

---

Read these simple guidelines. Not following them may be dangerous or illegal. Read the complete user guide for further information.



**Road safety comes first**  
Obey all local laws. Always keep your hands free to

operate the vehicle while driving. Your first consideration while driving should be road safety.



### Interference

All wireless devices may be susceptible to interference, which could affect performance.

## Introduction

---

With the Nokia Speakerphone HF-200, you can make and answer calls hands free. You can connect the speakerphone to a compatible mobile device that supports Bluetooth wireless technology.

Read this user guide carefully before using the speakerphone. Also, read the

user guide for the device that you connect to the speakerphone. It provides important safety and maintenance information. Check [www.nokia.com/support](http://www.nokia.com/support) or your local Nokia website for the latest version of the user guide and additional

information related to your Nokia product.

This product may contain small parts. Keep them out of the reach of small children.

### **Bluetooth wireless technology**

In a Bluetooth connection, the mobile device and the speakerphone should be within 10 metres (33 feet) of each

other. Connections can be subject to interference from other electronic devices.

The speakerphone complies with the Bluetooth Specification 2.0 that supports the Handsfree Profile 1.5. Check with the manufacturers of other devices to determine their compatibility with this device.

## **Get started**

---

The speakerphone contains the following parts shown on the title page: microphone (1), indicator light (2), answer/end key (3), volume down key (4), volume up key (5), speaker (6), and charger connector (7).

Before using the speakerphone, you must charge the battery and pair the speakerphone with a compatible device.

Parts of the speakerphone are magnetic. Metallic materials may be attracted to the speakerphone. Do not place credit cards or other magnetic storage media near the speakerphone, because information stored on them may be erased.

### **Chargers**

The speakerphone is intended for use when supplied with power from the AC-3, AC-4, AC-5, and DC-4 chargers.



**Warning:** Use only chargers approved by Nokia for use with this particular

enhancement. The use of any other types may invalidate any approval or warranty, and may be dangerous.

When you disconnect the power cord of any enhancement, grasp and pull the plug, not the cord.

## Charge the battery

Before charging the battery, carefully read "Battery information".

1. Connect the charger cable to the charger connector.
2. Connect the charger to the power source. The red indicator light is displayed while charging.

If you use a charger that is connected to the cigarette lighter socket, power must be supplied by a 12-volt car battery. Ensure that the charger is properly inserted in the cigarette lighter socket and

does not interfere with the normal operation of the car.

In some car models, the cigarette lighter socket is powered by the car battery even when you remove the ignition key. In those cases, the car battery might be discharged even if the speakerphone is not used. For more information, contact the vehicle manufacturer.

If charging does not start, disconnect the charger and plug it in again. Charging the battery fully may take up to 2 hours and 30 minutes.

3. When the battery is fully charged, the indicator light turns off. Disconnect the charger from the speakerphone and the power source.

The fully charged battery has power for up to 15 hours of talk time or up to 150 hours of standby time.

When battery power is low, the red indicator light flashes slowly.

Recharge the battery.

## Switch on or off

To switch on, press and hold the answer/end key until the speakerphone beeps and the green indicator light turns on. The indicator light flashes until the speakerphone succeeds in connecting to a paired device.

To switch off, press and hold the answer/end key until the red indicator light is briefly displayed.

If the speakerphone is not connected to a paired device within about 5 minutes, it switches off automatically to save power.

## Pair with another device

1. Ensure that your mobile device is switched on.
2. If you have not previously paired the speakerphone with a device, switch on the speakerphone. The green indicator light flashes slowly.  
If you have previously paired the speakerphone with a device, disconnect the speakerphone from the current device. Then switch off the speakerphone and switch it on again.
3. Activate the Bluetooth feature on the mobile device, and set the device to search for Bluetooth devices. See the user guide of your device for instructions.
4. Select the speakerphone (Nokia HF-200) from the list of found devices.
5. Enter the Bluetooth passcode 0000 to pair and connect the speakerphone to your device. In some devices, you may need to

make the connection separately after pairing.

If pairing succeeds, the speakerphone is shown in the list of currently paired Bluetooth devices in your mobile device.

When the speakerphone is connected to your mobile device and is ready for use, the green indicator light is continuously displayed.

You can pair the speakerphone with up to eight devices but connect it to only one device at a time.

When you switch on the speakerphone, it tries to connect to the device that was first paired with it.

If the connection fails, the speakerphone tries to connect to one of the other paired devices. To reconnect the speakerphone when it is on but not connected to a device, ensure that the other device is on, and press the answer/end key; or make the connection in the Bluetooth menu of your device.

You may be able to set your mobile device so that the speakerphone connects to it automatically. To activate this feature in a Nokia device, change the paired device settings in the Bluetooth menu.

## Installation in a car

---

You can attach the speakerphone to the sunvisor of your car using the supplied clip.

### General safety instructions

When you install the speakerphone in a car, ensure that it does not interfere with or hinder the systems used in the



operation of the vehicle (for example, airbags) or disturb your field of vision while driving.

Check that the deployment of the airbags is not blocked or impaired in any way. Only operate the speakerphone if it is safe to do so under all driving conditions.

To use the speakerphone when it is attached to the sunvisor, ensure that the sunvisor is up at the car roof (8).

### **Attach the speakerphone to the clip**

To attach the speakerphone to the clip, turn the speakerphone sideways, push it towards the clip (9), and turn it clockwise (10) until it locks into place.

To detach the speakerphone, turn it counterclockwise, and pull it away from the clip.

### **Attach the clip to the sunvisor**

To attach the clip to the sunvisor, slide the clip (and the speakerphone attached to it) around the sunvisor from the driver's or passenger's side.

Push the clip towards the sunvisor (11), and pull the strap attached to the clip (12 and 13). Firmly press the hook and loop end of the strap against the felt on the strap (14) to keep the speakerphone securely in place. Fold the sunvisor up against the car roof (15). Check that the speakerphone is in the correct position (16).

## **Basic use**

---

### **Adjust volume**

To adjust the speakerphone volume

during a call, use the volume keys.



**Warning:** Do not hold the device near your ear when the loudspeaker is in use, because the volume may be extremely loud.

## Calls

To make a call, use your mobile device in the normal way when the speakerphone is connected to it. Speak towards the speakerphone microphone. For optimal performance, check that there are no objects in front of the microphone and that the microphone is in front of you. During a call, the green indicator light is displayed.

If your device supports last number redial with the speakerphone, press the answer/end key twice when no call is in progress.

If your device supports voice dialling with the speakerphone, press the answer/end key when no call is in

progress, and proceed as described in the user guide of your device.

To answer the call, press the answer/end key. To reject the call, press the answer/end key twice. When you receive a call, you hear a ringing tone through the speakerphone.

To end a call, press the answer/end key. The speakerphone beeps.

To switch an active call from the speakerphone to your device, press and hold the answer/end key. To switch the call back to the speakerphone, press the answer/end key.

## Clear settings or reset

To clear the pairing settings from the speakerphone, press and hold the answer/end key and the volume up key at the same time for about 10 seconds. When the settings are

cleared, the red and green indicator lights alternate.

To reset the speakerphone if it stops functioning even though it is charged, press and hold the answer/end key, and plug the speakerphone into a charger. To use the speakerphone, reconnect it to your mobile device.

## Battery information

---

This device has an internal, nonremovable, rechargeable battery. Do not attempt to remove the battery from the device as you may damage the device. The battery can be charged and discharged hundreds of times, but it will eventually wear out. Recharge your battery only with Nokia approved chargers designated for this device. Use of an unapproved charger may present a risk of fire, explosion, leakage, or other hazard.

### Troubleshooting

If you cannot connect the speakerphone to your compatible device, check that the speakerphone is charged, switched on, and paired with your device.

Unplug the charger from the electrical plug and the device when not in use. Do not leave a fully charged battery connected to a charger, since overcharging may shorten its lifetime. If left unused, a fully charged battery will lose its charge over time.

Always try to keep the battery between 15°C and 25°C (59°F and 77°F). Extreme temperatures reduce the capacity and lifetime of the battery. A device with a hot or cold battery may not work temporarily. Battery performance is

particularly limited in temperatures well below freezing.

Do not dispose of batteries in a fire as they may explode. Batteries may also explode if damaged.

Improper battery use may result in a fire, explosion, or other hazard. If the device is dropped, especially on a hard surface, and you believe the battery has been damaged, take it to a service centre for inspection before continuing to use it.

## Care and maintenance

Your device is a product of superior design and craftsmanship and should be treated with care. The following suggestions will help you protect your warranty coverage.

- Keep the device dry. Precipitation, humidity, and all types of liquids or moisture can contain minerals that will corrode electronic circuits. If your

Never use any charger that is damaged.



**Important:** Battery talk and standby times are estimates only and depend on network conditions, features used,

battery age and condition, temperatures to which battery is exposed, and many other factors. The amount of time a device is used for calls will affect its standby time. Likewise, the amount of time that the device is turned on and in the standby mode will affect its talk time.

device does get wet, allow it to dry completely.

- Do not use or store the device in dusty, dirty areas. Its moving parts and electronic components can be damaged.
- Do not store the device in hot areas. High temperatures can shorten the life of electronic devices, damage

batteries, and warp or melt certain plastics.

- Do not store the device in cold areas. When the device returns to its normal temperature, moisture can form inside the device and damage electronic circuit boards.
- Do not attempt to open the device.
- Do not drop, knock, or shake the device. Rough handling can break internal circuit boards and fine mechanics.
- Do not use harsh chemicals, cleaning solvents, or strong detergents to clean the device.
- Do not paint the device. Paint can clog the moving parts, microphone, or speaker and prevent proper operation.

These suggestions apply equally to your device, charger, or any enhancement. If any device is not working properly, take it to the nearest authorised service facility for service.



### Disposal

The crossed-out wheeled-bin symbol on your product, literature, or packaging reminds you that all electrical and electronic products, batteries, and accumulators must be taken to separate collection at the end of their working life. This requirement applies to the European Union and other locations where separate collection systems are available. Do not dispose of these products as unsorted municipal waste.

By returning the products to collection you help prevent uncontrolled waste disposal and promote the reuse of material resources. More detailed information is available from the product retailer, local waste authorities, national producer responsibility organizations, or your local Nokia representative. For the product Eco-Declaration or instructions for returning your obsolete product, go to country-specific information at [www.nokia.com](http://www.nokia.com).

---

## Additional safety information

---

### ■ Vehicles

RF signals may affect improperly installed or inadequately shielded electronic systems in motor vehicles such as electronic fuel injection systems, electronic antiskid (antilock) braking systems, electronic speed control systems, and air bag systems. For more information, check with the manufacturer, or its representative, of your vehicle or any equipment that has been added.

Faulty installation or service may be dangerous and may invalidate any warranty that may apply to the device. Check regularly that all wireless device equipment in your vehicle is mounted and operating properly. Do not store or carry flammable liquids, gases, or explosive materials in the same compartment as the device, its parts, or

enhancements. For vehicles equipped with an air bag, remember that air bags inflate with great force. Do not place objects, including installed or portable wireless equipment in the area over the air bag or in the air bag deployment area. If in-vehicle wireless equipment is improperly installed and the air bag inflates, serious injury could result.