

Nokia 5330 Mobile TV Edition User Guide

Issue 2

Contents

Safety 4

Get started 5

Keys and parts	5
Insert the SIM card and battery	6
Insert and remove the memory card	6
Charge the battery	7
Antenna	8
Accessories	8

Switch it on 9

About your device	9
Network services	10
Access codes	10
Switch the device on and off	11
Standby mode	11
Touch music keys	13
Navigate the menus	14
Lock the keys	15
Functions without a SIM card	15
Flight profile	15

Make it your device 16

Basic settings	16
Personalise your phone	17
Connect	20
Network provider services	23

Stay in touch 24

Make calls	25
Text and messages	27
Nokia Messaging IM	31
Nokia Messaging Mail	33

Image and video 34

Capture images	34
Record video clips	35
Camera and video settings	35
Gallery	36
Print images	37
Memory card	37

Entertainment 38

Listen to music	38
Web	41
Games and applications	43

Mobile TV 44

About Mobile TV	44
Initial start-up	45
Select a channel or programme	45
Change audio output	46
Electronic Programme Guide (EPG)	46
Subscribe to a channel	46
Mobile TV settings	47
Access Mobile TV after changing SIM card	47

Maps 48

Download maps	48
---------------	----

Maps and GPS	49
Extra services	49

Organise 50

Manage contacts	50
Business cards	51
Date and time	52
Alarm clock	52
Calendar	52
To-do list	52
Notes	53
Calculator	53
Countdown timer	53
Stopwatch	53

Support and updates 54

Support	54
My Nokia	54
Download content	55
Update software using your PC	55
Software updates over the air	55
Restore factory settings	56

Green tips 56

Save energy	56
Recycle	57
Learn more	57

Product and safety information 57

Index 65

Safety

Read these simple guidelines. Not following them may be dangerous or illegal. Read the complete user guide for further information.

SWITCH ON SAFELY



Do not switch the device on when wireless phone use is prohibited or when it may cause interference or danger.

ROAD SAFETY COMES FIRST



Obey all local laws. Always keep your hands free to operate the vehicle while driving. Your first consideration while driving should be road safety.

INTERFERENCE



All wireless devices may be susceptible to interference, which could affect performance.

SWITCH OFF IN RESTRICTED AREAS



Follow any restrictions. Switch the device off in aircraft, near medical equipment, fuel, chemicals, or blasting areas.

QUALIFIED SERVICE



Only qualified personnel may install or repair this product.

ACCESSORIES AND BATTERIES



Use only approved accessories and batteries. Do not connect incompatible products.

WATER-RESISTANCE



Your device is not water-resistant. Keep it dry.

Get started

Get to know your device, insert the battery, SIM card, and memory card, and learn some important information about your device.

Keys and parts

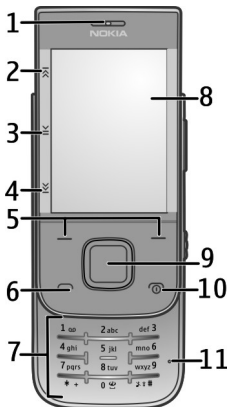

- 1 Earpiece
- 2 Touch music key (rewind)
- 3 Touch music key (play/pause)
- 4 Touch music key (fast-forward)
- 5 Left and right selection keys
- 6 Call key

- 7 Keypad
- 8 Display
- 9 Navi™ key (scroll key)
- 10 End/Power key

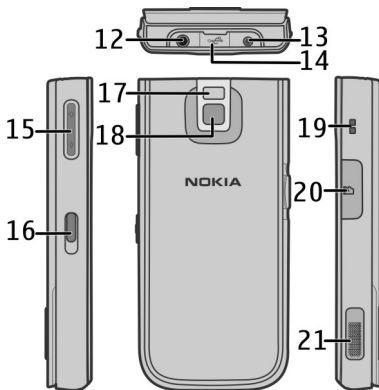

- 11 Microphone
- 12 Nokia AV Connector (3.5 mm)
- 13 Charger connector
- 14 Micro USB cable connector
- 15 Volume key
- 16 Lock switch
- 17 Camera flash
- 18 Camera lens
- 19 Wrist strap eyelet
- 20 Memory card slot
- 21 Loudspeaker

Insert the SIM card and battery

Note: Switch off the power and disconnect the charger and any other device before removing the covers. Avoid touching electronic components while changing the covers. Always store and use the device with the covers attached.

The SIM card and its contacts can be easily damaged by scratches or bending, so be careful when handling, inserting, or removing the card.

- 1 Open the back cover, and remove it. Remove the battery.

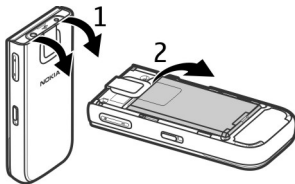

- 2 Open the SIM card holder. Insert the SIM card into the holder with the contact surface facing down. Close the SIM card holder.

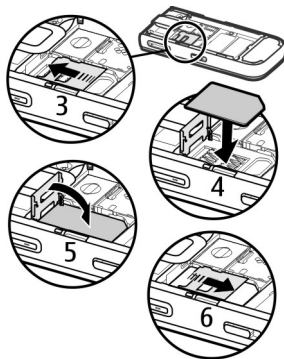

- 3 Line up the battery contacts, and insert the battery. Replace the back cover.

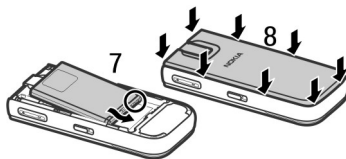
**Insert and remove the memory card**

Use only compatible microSD cards approved by Nokia for use with this device. Nokia uses approved industry standards for memory cards, but some brands may not be fully compatible with this device. Incompatible cards may damage the card and the device and corrupt data stored on the card.

Your device supports microSD cards with a capacity of up to 16 GB. The size of a single file must not exceed 2 GB.

Insert the memory card

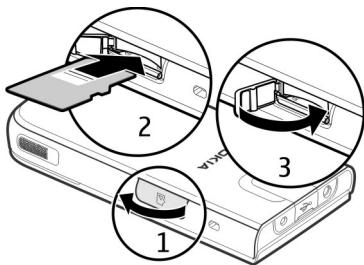

- 1 Open the cover of the memory card slot.
- 2 Insert the card into the memory card slot with the contact surface facing down, and press until it locks into place.

- 3 Close the cover of the memory card slot.

Remove the memory card

Important: Do not remove the memory card during an operation when the card is being accessed. Doing so may damage the memory card and the device, and corrupt data stored on the card.

You can remove or replace the memory card without switching the device off.

- 1 Ensure that no application is currently accessing the memory card.
- 2 Open the cover of the memory card slot.
- 3 Press the memory card slightly in to release the lock, and remove the card.

Charge the battery

Your battery has been partially charged at the factory. If the device indicates a low charge, do the following:

- 1 Connect the charger to a wall outlet.



8 Get started

- 2 Connect the charger to the device.
- 3 When the device indicates a full charge, disconnect the charger from the device, then from the wall outlet.

You can also charge the battery with a USB cable with power from a computer.

- 1 Connect the USB cable to a USB port of a computer and to your device.
- 2 When the battery is fully charged, disconnect the USB cable.

You do not need to charge the battery for a specific length of time, and you can use the device while it is charging. If the battery is completely discharged, it may take several minutes before the charging indicator appears on the display or before any calls can be made.

Antenna



Your device may have internal and external antennas. Avoid touching the antenna area unnecessarily while the antenna is transmitting or receiving. Contact with antennas affects the communication quality and may cause a higher power level during operation and may reduce the battery life.

The figure shows the antenna area marked in grey.

Accessories

Connect a USB cable



Open the cover of the USB connector, and connect the USB cable to the device.

Headset

Warning:

Continuous exposure to high volume may damage your hearing. Listen to music at a moderate level, and do not hold the device near your ear when the loudspeaker is in use.

Warning:

When you use the headset, your ability to hear outside sounds may be affected. Do not use the headset where it can endanger your safety.

When connecting any external device or any headset, other than those approved by Nokia for use with this device, to the Nokia AV Connector, pay special attention to volume levels.

Do not connect products that create an output signal as this may cause damage to the device. Do not connect any voltage source to the Nokia AV Connector.

Strap

- 1 Remove the back cover.
- 2 Attach a strap, and tighten it.
- 3 Replace the back cover.

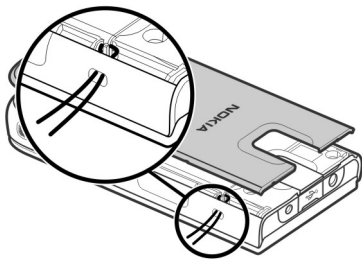

Switch it on

Learn how to switch on your device, and how to use the basic functions.

About your device

The wireless device described in this guide is approved for use on the GSM 850, 900, 1800, 1900 MHz and WCDMA 850, 1900, 2100 MHz networks. Contact your service provider for more information about networks.

Your device may have preinstalled bookmarks and links for third-party internet sites and may allow you to access third-party sites. These are not affiliated with Nokia, and Nokia does not endorse or assume liability for them. If you access such sites, take precautions for security or content.

Warning:

To use any features in this device, other than the alarm clock, the device must be switched on. Do not switch the device on when wireless device use may cause interference or danger.

When using this device, obey all laws and respect local customs, privacy and legitimate rights of others, including copyrights. Copyright protection may prevent some images, music, and other content from being copied, modified, or transferred.

Make back-up copies or keep a written record of all important information stored in your device.

When connecting to any other device, read its user guide for detailed safety instructions. Do not connect incompatible products.

The images in this guide may differ from your device display.

Refer to the user guide for other important information about your device.

Network services

To use the device you must have service from a wireless service provider. Some

features are not available on all networks; other features may require that you make specific arrangements with your service provider to use them. Network services involve transmission of data. Check with your service provider for details about fees in your home network and when roaming on other networks. Your service provider can explain what charges will apply.

Your service provider may have requested that certain features be disabled or not activated in your device. If so, these features will not appear on your device menu. Your device may also have customized items such as menu names, menu order, and icons.

Access codes

To set how your phone uses the access codes and security settings, select **Menu > Settings > Security > Access codes**.

- The security code helps to protect your phone against unauthorised use. The preset code is 12345. You can change the code and set the phone to request the code. Some operations require the security code regardless of the settings, for example if you want to restore the factory settings. Keep the code

secret and in a safe place separate from your phone. If you forget the code and your phone is locked, your phone will require service and additional charges may apply. For more information, contact a Nokia Care point or your phone dealer.

- The PIN (UPIN) code, supplied with the SIM (USIM) card, helps to protect the card against unauthorised use.
- The PIN2 (UPIN2) code, supplied with some SIM (USIM) cards, is required to access certain services.
- PUK (UPUK) and PUK2 (UPUK2) codes may be supplied with the SIM (USIM) card. If you enter the PIN code incorrectly three times in succession, you are asked for the PUK code. If the codes are not supplied, contact your service provider.
- The barring password is required when using the call barring service to restrict calls to and from your phone (network service).

Switch the device on and off

Switch on and off

Press and hold the power key.

Enter the PIN code

If requested, enter the PIN code (displayed as ****).

Set the time and date

If requested, enter the date, the local time, and the time zone and the daylight saving time of your location.

When you switch on your device for the first time, you may be prompted to get the configuration settings from your service provider (network service). For more information, contact your service provider.

Standby mode

When the phone is ready for use, and you have not entered any characters, the phone is in the standby mode.

Display

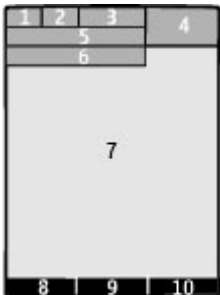

- 1 Signal strength of the cellular network 
- 2 Battery charge status
- 3 Indicators
- 4 Clock
- 5 Name of the network or the operator logo
- 6 Date (only if the Home screen is deactivated)
- 7 Display
- 8 Function of the left selection key
- 9 Function of the Navi key (scroll key)
- 10 Function of the right selection key

You may change the function of the left and right selection key. [See " Left and right selection keys ", p. 19.](#)

Home screen

The home screen displays a list of selected features and information that you can directly access.

Select **Menu > Settings > Display > Home screen.**

Activate the home screen

Select **Home screen mode.**

Organise and personalise the home screen

Select **Personalise view.**

Select a key to activate the home screen

Select **Home screen key.**

Navigate in the home screen

Scroll up or down to navigate in the list, and select **Select, View, or Edit.** The arrows indicate that further information is available.

Stop navigating

Select **Exit.**

Shortcuts

When your device is in the standby or home screen mode, you can use the following shortcuts.

List missed, received, and dialled calls

Press the call key. To make a call, scroll to the number or name, and press the call key.

Start the web browser

Press and hold 0.

Call the voice mailbox

Press and hold 1.

Use other keys as shortcuts

[See "Dialling shortcuts", p. 25.](#)

Indicators



You have unread messages.



You have unsent, cancelled, or failed messages.



The keypad is locked.



The device does not ring for incoming calls or text messages.



An alarm is set.



The device is registered to the GPRS or EGPRS network.



A GPRS or EGPRS connection is open.



The GPRS or EGPRS connection is suspended (on hold).



Bluetooth connectivity is activated.



A GPS signal is available. (external GPS antenna necessary).



No GPS signal available. (external GPS antenna necessary).



If you have two phone lines, the second line is in use.



All incoming calls are diverted to another number.



Calls are limited to a closed user group.



The currently active profile is timed.

Touch music keys

When listening to the FM radio, or using the media player, to pause or resume playback, skip songs, or switch between saved stations, use the touch music keys.

The figure shows the three touch-sensitive areas marked in grey.

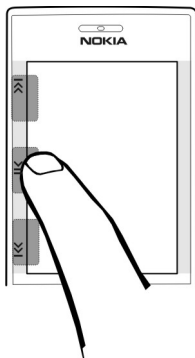

Activate the touch music keys

Select **Menu > Settings > Phone > Touch music keys**.

Control the radio

Select **Menu > Media > Radio**. Use the touch music keys to pause or resume playback, and to switch between saved radio stations.

Control the media player

Select **Menu > Media > Media player > Go to Media player**. Use the touch music keys to pause or resume playback, and to skip songs.

To re-activate the radio or media player, press and hold **⏮**.

Navigate the menus

The phone offers you an extensive range of functions that are grouped into menus.

- 1 To access the menu, select **Menu**.
- 2 Scroll through the menu, and select an option (for example, **Settings**).
- 3 If the selected menu contains further submenus, select one (for example, **Call**).
- 4 Select the setting of your choice.
- 5 To return to the previous menu level, select **Back**.
To exit the menu, select **Exit**.

To change the menu view, select **Options > Main menu view**. Scroll right, and select from the available options.

To rearrange the menu, select **Options > Organise**. Scroll to the menu item to be moved, and select **Move**. Scroll to where you want to move the menu item, and select **OK**. To save the change, select **Done > Yes**.

Lock the keys

To prevent accidental key presses, lock the touch music keys and the keypad.

Lock or unlock the keys

Slide the lock switch on the side of the device. Alternatively, close or open the slide.

Handle calls when the keys are locked

To answer a call when the keypad is locked, press the call key. When you end or reject a call, the keypad locks automatically.

When the device or keypad is locked, calls may be possible to the official emergency number programmed into your device.

Functions without a SIM card

Some functions of your phone may be used without inserting a SIM card, such as Organiser functions and games. Some functions appear dimmed in the menus and cannot be used.

Flight profile

Use the Flight profile in radio sensitive environments to deactivate all radio frequency functions. You still have access to offline games, the calendar,

and phone numbers. When the Flight profile is active,  is displayed.

Activate the Flight profile

Select **Menu > Settings > Profiles > Flight > Activate or Personalise.**

Deactivate the Flight profile

Select any other profile.

Warning:

With the Flight profile you cannot make or receive any calls, including emergency calls, or use other features that require network coverage. To make calls, you must first activate the phone function by changing profiles. If the device has been locked, enter the lock code.

If you need to make an emergency call while the device is locked and in the Flight profile, you may be also able to enter an official emergency number programmed in your device in the lock code field and select 'Call'. The device will confirm that you are about to exit Flight profile to start an emergency call.

Make it your device

Set up your device, personalise it, and connect it in several ways.

Basic settings

Phone settings

Select **Menu > Settings and Phone**.

Select from the following:

Language settings — To set the language of your device, select **Phone language** and a language. To set the language of your device according to the information on the SIM card, select **Phone language > Automatic**.

Touch music keys — Activate the touch music keys.

Memory status — View the memory consumption.

Automatic keyguard — Set the keypad to lock automatically after a preset time delay when the device is in the home screen and no function has been used.

Security keyguard — Set the device to prompt for the security code to unlock the keypad.

Voice recognition — Set up voice commands, or start voice recognition training.

Flight query — Set the device to prompt for the flight profile when you switch the device on. In the flight profile, all radio connections are closed.

Phone updates — Allow software updates from your service provider (network service). The available options may vary.

Network mode — To use GSM and (when available) 3G networks, select **Dual mode**. This option is not available during an active call.

Operator selection — Manually select which network to use.

Help text activation — Set the device to display help text.

Start-up tone — Play a tone when you switch the device on.

Confirm SIM actions — Access additional network services from your SIM card. This option may not be available, depending on your SIM card.

Security settings

Select **Menu > Settings and Security**.

When security features that restrict calls are in use (such as call barring, closed user group, and fixed dialling), calls may be possible to the official emergency number programmed into your device.

Call barring and call diverting cannot be active at the same time.

Select from the following:

PIN code request or **UPIN code request** — Set the device to request for the PIN or UPIN code every time the device is switched on. Some SIM cards do not allow the code request to be deactivated.

Call barring service — Restrict incoming calls to and outgoing calls from your device (network service). A barring password is required.

Fixed dialling — Restrict your outgoing calls to selected phone numbers if supported by your SIM card. When fixed dialling is activated, GPRS connections are not possible except while sending text messages over a GPRS connection. In this case, the recipient's phone number and the message centre number must be included in the fixed dialling list.

Closed user group — Define a group of people whom you can call and who can call you (network service).

Security level — To request the security code whenever a new SIM card is inserted into the device, select **Phone**.

Access codes — Change the security code, PIN code, UPIN code, PIN2 code, or barring password.

PIN2 code request — Set the device to request the PIN2 code when using a specific device feature protected by the PIN2 code. Some SIM cards do not allow the code request to be deactivated. This option may not be available depending on your SIM card. For details, contact your service provider.

Code in use — Display and select the type of PIN code to be used.

Authority certificates or **User certificates** — View the list of the authority or user certificates available on your device.

Security module sett. — View Secur. module details, activate **Module PIN request**, or change the module PIN and signing PIN.

Personalise your phone

Give your phone a personal touch with ringing tones, display backgrounds, and themes. Add shortcuts for your preferred features, and attach enhancements.

Profiles

Your phone has various setting groups called profiles, which you can customise

with ringing tones for different events and environments.

Select **Menu** > **Settings** > **Profiles**, the desired profile, and from the following options:

Activate — to activate the selected profile

Personalise — to change the profile settings

Timed — to set the profile to be active for a certain time. When the time set for the profile expires, the previous profile that was not timed becomes active.

Themes

A theme contains elements for personalising your phone.

Select **Menu** > **Settings** > **Themes** and from the following options:

Select theme — Open the **Themes** folder, and select a theme.

Theme downloads — Open a list of links to download more themes.

Tones

You can change the tone settings of the selected active profile.

Select **Menu** > **Settings** > **Tones**. You can find the same settings in the **Profiles** menu.

Lights

Personalise your device with light effects associated with different functions. Select **Menu** > **Settings** and **Lights**.

Choose a colour

Select **Light colours** and a colour.

Activate light effects

Select **Light effects**.

Display

Select **Menu** > **Settings** > **Display** and from the following:

Wallpaper — to add a background image for the home screen mode

Home screen — to activate, organise, and personalise the home screen mode

Home screen font col. — to select the font colour for the home screen mode

Navigation key icons — to display the scroll key icons in the home screen mode

Notification details — to display details in missed call and message notifications

Screen saver — to create and set a screen saver

Font size — to set the font size for messaging, contacts, and web pages

Operator logo — to display the operator logo

Cell info display — to display the cell identity, if available from the network

My shortcuts

With personal shortcuts, you get quick access to frequently used functions of your phone.

Left and right selection keys

To change the function assigned to the left or right selection key, select **Menu > Settings > My shortcuts > Left selection key** or **Right selection key**, and the desired function.

In the home screen mode, if the left selection key is **Go to**, to activate a function, select **Go to > Options** and from the following:

Select options — to add or remove a function

Organise — to rearrange the functions

Other shortcuts

Select **Menu > Settings > My shortcuts** and from the following:

Navigation key — to assign other functions from a predefined list to the navigation key (scroll key)

Home screen key — to select the movement of the navigation key to activate the home screen mode

Assign dialling shortcuts

Create shortcuts by assigning phone numbers to the number keys 2-9.

- 1 Select **Menu > Contacts > Speed dials**, and scroll to a number key.
- 2 Select **Assign**, or, if a number has already been assigned to the key, select **Options > Change**.
- 3 Enter a number or search for a contact.

Voice commands

You can use voice commands to make phone calls, launch applications, and activate profiles.

Select **Menu > Settings > Phone**.

Voice commands are language-dependent. To set the language, select **Language settings > Phone language** and the language.

To train the voice recognition of your device to your voice, select **Voice recognition** > **Voice recog. training**.

To activate a voice command for a function, select **Voice recognition** > **Voice commands**, a feature, and the function.  indicates that the voice command is activated.

To activate the voice command, select **Add**.

To play the activated voice command, select **Play**.

To use voice commands, see "[Voice dialling](#)", p. 25.

To manage voice commands, scroll to a function, select **Options** and from the following:

Edit or Remove — to rename or deactivate the voice command

Add all or Remove all — to activate or deactivate voice commands for all functions in the voice commands list

Connect

Your phone provides several features to connect to other devices to transmit and receive data.

Bluetooth wireless technology

Bluetooth technology allows you to connect your device, using radio waves, to a compatible Bluetooth device within 10 metres (32 feet).

This device is compliant with Bluetooth Specification 2.1 + EDR supporting the following profiles: SIM access, object push, file transfer, headset, handsfree, generic access, serial port, generic object exchange, advanced audio distribution, audio video remote control, service discovery application, personal area networking, phonebook access, and generic audio/video distribution. To ensure interoperability between other devices supporting Bluetooth technology, use Nokia approved accessories for this model. Check with the manufacturers of other devices to determine their compatibility with this device.

Features using Bluetooth technology increase the demand on battery power and reduce the battery life.

When the wireless device is in the remote SIM mode, you can only use a compatible connected accessory, such as a car kit, to make or receive calls.

Your wireless device will not make any calls, except to the emergency numbers

programmed into your device, while in this mode.

To make calls, you must first leave the remote SIM mode. If the device has been locked, enter the lock code to unlock it first.

Open a Bluetooth connection

- 1 Select **Menu > Settings > Connectivity > Bluetooth**.
- 2 Select **My phone's name**, and enter a name for your device.
- 3 To activate Bluetooth connectivity, select **Bluetooth > On**.  indicates that Bluetooth connectivity is active.
- 4 To connect your device to an audio accessory, select **Conn. audio access.** and the accessory.
- 5 To pair your device with any Bluetooth device in range, select **Paired devices > Add new device**.
- 6 Scroll to a found device, and select **Add**.
- 7 Enter a passcode (up to 16 characters) on your device, and allow the connection on the other Bluetooth device.

Operating the device in hidden mode is a safer way to avoid malicious software.

Do not accept Bluetooth connectivity from sources you do not trust. Alternatively, switch off the Bluetooth function. This does not affect other functions of the device.

Connect your PC to the internet

You can use Bluetooth technology to connect your compatible PC to the internet. Your device must be able to connect to the internet (network service), and your PC must support Bluetooth technology. After connecting to the network access point (NAP) service of the device and pairing with your PC, your device automatically opens a packet data connection to the internet.

Packet data

General packet radio service (GPRS) is a network service that allows mobile phones to send and receive data over an internet protocol (IP)-based network.

To define how to use the service, select **Menu > Settings > Connectivity > Packet data > Packet data conn.** and from the following options:

When needed — to establish the packet data connection when an application needs it. The connection is

closed when the application is terminated.

Always online — to automatically connect to a packet data network when you switch the phone on

You can use your phone as a modem by connecting it to a compatible PC using Bluetooth technology. For details, see the Nokia PC Suite documentation.

USB data cable

You can use the USB data cable to transfer data between the phone and a compatible PC or a printer supporting PictBridge.

To activate the phone for data transfer or image printing, connect the data cable and select the mode:

PC Suite — to use the cable for Nokia PC Suite

Printing & media — to use the phone with a PictBridge compatible printer or with a compatible PC

Data storage — to connect to a PC that does not have Nokia software and use the phone as data storage

To change the USB mode, select **Menu > Settings > Connectivity > USB data cable** and the desired USB mode.

Synchronisation and backup

Select **Menu > Settings > Sync and backup** and from the following:

Phone switch — Synchronise or copy selected data between your device and another device using Bluetooth technology.

Create backup — Create a backup of selected data.

Restore backup — Select a stored backup file, and restore it to the device. Select **Options > Details** for information about the selected backup file.

Data transfer — Synchronise or copy selected data between your device and another device, PC, or network server (network service).

Connect a USB device

You can connect a USB storage (for example, a memory stick) to your device and browse in the file system and transfer files.

- 1 Connect a compatible adapter cable to the USB port of your device.
- 2 Connect the USB storage to the adapter cable.
- 3 Select **Menu > Gallery** and the USB device to browse.

Note: Not all USB storage devices are supported, depending on their power consumption.

Nokia PC Suite

With Nokia PC Suite, you can manage your music and synchronise contacts, calendar entries, notes, and to-do notes between your device and a compatible PC or a remote internet server (network service). For more information, and to download PC Suite, visit www.nokia.com/support.

Network provider services

Your network provider provides several additional services you may want to use. For some of these services, charges may apply.

Operator menu

Access a portal to services provided by your network operator. For more information, contact your network operator. The operator can update this menu with a service message.

SIM services

Your SIM card may provide additional services. You can access this menu only if it is supported by your SIM card. The name and contents of the menu depend on the available services.

Accessing these services may involve sending messages or making a phone call for which you may be charged.

Position log

The network may send you a position request (network service). To subscribe and agree upon the delivery of positioning information, contact your service provider.

To accept or reject the position request, select **Accept** or **Reject**. If you miss the request, the phone automatically accepts or rejects it according to what you have agreed with your network operator or service provider.

To view the information on the 10 most recent privacy notifications and requests, select **Menu > Log > Positioning > Position log**.

Info messages, SIM messages, and service commands

Info messages

You can receive messages on various topics from your service provider (network service). For more information, contact your service provider.

Select **Menu > Messaging > Info messages** and from the available options.

Service commands

Service commands allow you to write and send service requests (USSD commands) to your service provider, such as activation commands for network services.

To write and send the service request, select **Menu > Messaging > Serv. commands**. For details, contact your service provider.

SIM messages

SIM messages are specific text messages that are saved to your SIM card. You can copy or move those messages from the SIM to the phone memory, but not vice versa.

To read SIM messages, select **Menu > Messaging > Options > SIM messages**.

Configuration settings

You can configure your device with settings that are required for certain services. You may receive these settings as a configuration message from your service provider.

Select **Menu > Settings**.

Select **Configuration** and from the following:

Default config. sett. — View the service providers saved in the device, and set a default service provider.

Act. def. in all apps. — Activate the default configuration settings for supported applications.

Preferred access pt. — View the saved access points.

Device manager sett. — Allow or prevent the device from receiving software updates. This option may not be available, depending on your device.

Personal config. sett. — Add manually new personal accounts for various services, and activate or delete them. To add a new personal account, select **Add or Options > Add new**. Select the service type, and enter the required parameters. To activate a personal account, scroll to the account, and select **Options > Activate**.

Stay in touch

Learn how to make calls, write text, send messages, and use the e-mail functionality of your device.

Make calls**Make a voice call****Dial a number manually**

Enter the phone number, including the area code, and press the call key.

For international calls, press * twice for the international prefix (the + character replaces the international access code), enter the country code, the area code without the leading 0, if necessary, and the phone number.

Redial a number

To access the list of dialled numbers, in the standby mode, press the call key. Select a number or name, and press the call key.

Call a contact

Select **Menu > Contacts and Names**. Select a contact, and press the call key.

Handle voice calls

To handle calls with the slide, select **Menu > Settings > Call > Slide call handling**.

Answer an incoming call

Press the call key, or open the slide.

End a call

Press the end key, or close the slide.

Mute the ringing tone

Select **Silence**.

Reject an incoming call

Press the end key.

Adjust the volume in a call

Use the volume keys.

Dialling shortcuts

Assign a phone number to one of the number keys, 2-9. [See "Assign dialling shortcuts", p. 19.](#)

Use a dialling shortcut to make a call in one of the following ways:

- Press a number key, then the call key.
- If **Menu > Settings > Call > Speed dialling > On** is selected, press and hold a number key.

Voice dialling

Make a phone call by saying the name that is saved in Contacts.

As voice commands are language-dependent, before voice dialling, you must select **Menu > Settings >**

Phone > **Language settings** > **Phone language** and your language.

Note: Using voice tags may be difficult in a noisy environment or during an emergency, so you should not rely solely upon voice dialling in all circumstances.

- 1 In the home screen mode, press and hold the right selection key. A short tone sounds, and **Speak after the tone** is displayed.
- 2 Say the name of the contact you want to dial. If the voice recognition is successful, a list of proposed matches is displayed. The phone plays the voice command of the first match on the list. If it is not the correct command, scroll to another entry.

Options during a call

Many of the options that you can use during a call are network services. For availability, contact your service provider.

During a call, select **Options** and from the available options.

Some of the network options are **Hold**, **New call**, **Add to conference**, **End all calls**, and the following:

Send DTMF — to send tone strings

Swap — to switch between the active call and the call on hold

Transfer — to connect a call on hold to an active call and disconnect yourself

Conference — to make a conference call

Private call — to have a private discussion in a conference call

Voice messages

The voice mailbox is a network service to which you may need to subscribe. For more information, contact your service provider.

Call your voice mailbox

Press and hold **1**.

Edit your voice mailbox number

Select **Menu** > **Messaging** > **Voice messages** > **Voice mailbox no.**

Call log

To view the information on your calls, messages, data, and synchronisation, select **Menu** > **Log** and the desired item.

Note: The actual invoice for calls and services from your service provider may

vary, depending on network features, rounding off for billing, taxes, and so forth.

Call settings

Select **Menu > Settings** and **Call** and from the following:

Call divert — Divert your incoming calls (network service). You may not be able to divert your calls if some call barring functions are active.

Anykey answer — Answer an incoming call by briefly pressing any key, except the power key, the left and right selection keys, or the end key.

Automatic redial — The device redials the number automatically if a call fails. The device tries to call the number 10 times.

Voice clarity — Improve speech intelligibility, especially in noisy environments.

Speed dialling — Dial the names and phone numbers assigned to the number keys (2-9) by pressing and holding the corresponding number key.

Call waiting — The network notifies you of an incoming call while you have a call in progress (network service).

Call duration display — Display the duration of the call in progress.

Summary after call — Briefly display the approximate duration after each call.

Send my caller ID — Show your phone number to the person you are calling (network service). To use the setting agreed upon with your service provider, select **Set by network**.

Outgoing call line — Select the phone line for making calls, if your SIM card supports multiple phone lines (network service).

Slide call handling — Answer or end a call by opening or closing the slide.



Text and messages



Write text, and create messages and notes.

Write text

Text modes

To enter text (for example, when writing messages) you can use traditional or predictive text input.

When you write text, press and hold **Options** to switch between traditional text input, indicated by , and predictive text input, indicated by . Not all languages are supported by predictive text input.

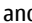
The character cases are indicated by , , and .

To change the character case, press **#**. To change from the letter to number mode, indicated by , press and hold **#**, and select **Number mode**. To change from the number to the letter mode, press and hold **#**.

To set the writing language, select **Options > Writing language**.

Traditional text input

Press a number key, 2-9, repeatedly until the desired character appears. The available characters depend on the selected writing language.

If the next letter you want is located on the same key as the present one, wait until the cursor appears, and enter the letter.

To access the most common punctuation marks and special characters, press **1** repeatedly. To access the list of special characters, press *****. To insert a space, press **0**.

Predictive text input

Predictive text input is based on a built-in dictionary to which you can also add new words.

- 1 Start writing a word, using the keys **2** to **9**. Press each key only once for one letter.
- 2 To confirm a word, scroll right or add a space.
 - If the word is not correct, press ***** repeatedly, and select the word from the list.
 - If the **?** character is displayed after the word, the word you intended to write is not in the dictionary. To add the word to the dictionary, select **Spell**. Enter the word using traditional text input, and select **Save**.
 - To write compound words, enter the first part of the word, and scroll right to confirm it. Write the last part of the word, and confirm the word.
- 3 Start writing the next word.

Text and multimedia messages

You can create a message and optionally attach, for example, a picture. Your phone automatically changes a text message to a multimedia message when a file is attached.

Text messages

Your device supports text messages beyond the limit for a single message. Longer messages are sent as two or more messages. Your service provider may charge accordingly. Characters with accents, other marks, or some language options take more space, and limit the number of characters that can be sent in a single message.

The total number of characters left and the number of messages needed for sending are displayed.

To send messages, the correct message centre number must be stored in your device. Normally, this number is set by default through your SIM card. To set the number manually, select **Menu > Messaging > Message settings > Text messages > Message centres > Add centre**, and enter a name and the number from the service provider.

Multimedia messages

A multimedia message can contain text, pictures, and sound or video clips.

Only devices that have compatible features can receive and display multimedia messages. The appearance of a message may vary depending on the receiving device.

The wireless network may limit the size of MMS messages. If the inserted picture exceeds this limit, the device may make it smaller so that it can be sent by MMS.

Important: Exercise caution when opening messages. Messages may contain malicious software or otherwise be harmful to your device or PC.

For availability and subscription to the multimedia messaging service (MMS), contact your service provider.

Create a text or multimedia message

- 1 Select **Menu > Messaging > Create message > Message**.
- 2 To add recipients, scroll to the **To:** field, and enter the recipient's number or e-mail address, or select **Add** to select recipients from the available options. Select **Options** to add recipients and subjects and to set sending options.
- 3 Scroll to the **Text:** field, and enter the message text.
- 4 To attach content to the message, scroll to the attachment bar at the bottom of the display, and select the desired type of content.
- 5 To send the message, select **Send**.

The message type is indicated at the top of the display and changes automatically depending on the content of the message.

Service providers may charge differently depending on the message type. For details, contact your service provider.

Read a message and reply

Important: Exercise caution when opening messages. Messages may contain malicious software or otherwise be harmful to your device or PC.

You get a notification when you receive a message. Select **View** to display the message. If more than one message was received, to display a message, select the message from the Inbox and **Open**. Use the scroll key to view all parts of the message.

To view a multimedia message automatically, select **Play**.

To reply to the message, select **Reply**.

Send and organise messages

To send a message, select **Send**. The phone saves the message in the Outbox folder, and the sending starts.

Note: The message sent icon or text on your device screen does not indicate that the message is received at the intended destination.

If message sending is interrupted, the phone tries to resend the message a few times. If these attempts fail, the message remains in the Outbox folder. To cancel message sending, in the Outbox folder, select **Options > Cancel sending**.

To save the sent messages in the Sent items folder, select **Menu > Messaging > Message settings > General settings > Save sent messages**.

The phone saves received messages in the Inbox folder. Organise your messages in the Saved items folder.

To add, rename, or delete a folder, select **Menu > Messaging > Saved items > Options**.

Flash messages

Flash messages are text messages that are instantly displayed upon reception.

- 1 To write a flash message, select **Menu > Messaging > Create message > Flash message**.

- 2 Enter the recipient's phone number, write your message (maximum 70 characters), and select **Send**.

Nokia Xpress audio messages

Create and send an audio message using MMS in a convenient way.

- 1 Select **Menu > Messaging > Create message > Audio message**. The voice recorder opens.
- 2 Record your message.
- 3 Enter one or more phone numbers in the **To:** field, or select **Add** to retrieve a number.
- 4 To send the message, select **Send**.

Message settings

Select **Menu > Messaging > Message settings** and from the following:

General settings — Save copies of sent messages in your device, overwrite old messages if the message memory becomes full, and set up other preferences related to messages.

Text messages — Allow delivery reports, set up message centres for SMS and SMS e-mail, select the type of character support, and set up other preferences related to text messages.

Multimedia messages — Allow delivery reports, set up the appearance of multimedia messages, allow the reception of multimedia messages and advertisements, and set up other preferences related to multimedia messages.

Service messages — Activate service messages, and set up preferences related to service messages.

Nokia Messaging IM

With instant messaging (IM) you can chat with other online users using your device.

You can use your already existing account with an IM community that is supported by your device.

If you are not registered to a IM service, you can create an IM account with a supported IM service, using your computer or your device. The menus may vary depending on the IM service.

IM services

Sign in to an existing IM account

- 1 Select **Menu > Messaging > IMs**.
- 2 Select an IM service.
- 3 Enter your account ID and password.

- 4 Follow the instructions on the display.

Create a new Nokia account

To create a Nokia account, which includes mail and IM services, using your PC, visit www.ovi.com. To create an account using your device, do the following:

- 1 Select **Menu** > **Messaging** > **E-mail**.
- 2 Follow the instructions on the display.

Use IM services simultaneously

- 1 To return to the IM main view, select **Home** from within any IM service.
- 2 Select an IM service, and sign in.
- 3 To switch between IM services, in the contacts list view, scroll left or right.

Exchange messages

Select **Menu** > **Messaging** > **IMs**.

Send an IM

- 1 Select an IM service.
- 2 Select a contact from the contacts list.
Each conversation is on a tab in the conversation view.

- 3 Enter your message in the text box at the bottom of the display.
- 4 Select **Send**.

Receiving messages

When a new message arrives in your current conversation, the message appears at the end of the chat history. When a new message arrives for another conversation, the corresponding conversation tab flashes. To switch between conversations, do the following:

- 1 Scroll up to the conversation tabs.
- 2 Scroll left or right to open a conversation.

When a new message arrives from another community, it is indicated at the top or bottom corner.

Scroll up, and select **Switch** or **Select**.

Notification settings

Even when you are not using the application, you are notified of new messages. To modify notification settings, do the following:

- 1 In the IM main view, select **Options** > **IM settings**.
- 2 Select a notification type and **Save**.

Leave the IM application

When you exit the Instant messaging (IM) application, you remain signed in to IM services. Your sessions remain active for a period of time, according to your service subscription. When the IM application is running in the background, you can open other applications, and return to using IM without signing in again.

Close the IM window

Go to the IM main view, and select **Exit**.

Sign out from IM

Select **Options > Sign Out**.

All conversations are closed.

Nokia Messaging Mail

Access your mail accounts from different providers with your mobile device to read, write, and send mail.

Before you can use mail, you must have an mail account. If you do not have already an mail account, create it in Ovi. The menus may vary depending on the mail provider.

Set up mail

You can sign in to an existing mail account or set up a new Ovi Mail account.

Select **Menu > Messaging > E-mail**.

Sign in to your mail account

- 1 Select your mail service provider.
- 2 Enter your account ID and password.
- 3 Select **Remember password** to disable the password query when you access your mail account.
- 4 Select **Sign In**.

To sign in to an additional mail account, select **Add account**.

Set up Ovi Mail

If you do not already have a mail account, you can create a Nokia account, which includes the Ovi Mail service.

- 1 Select **Get Ovi Mail**.
- 2 Follow the instructions on the display.

Once you have created your new Nokia account, you can sign in to the Ovi Mail service and start sending and receiving mail. You can also use the account to sign into other Ovi services, such as IM.

For more information, see www.ovi.com.

Read, create, and send mail

Select **Menu** > **Messaging** > **E-mail** and a mail account.

Read mail and reply

- 1 Select a mail and **Open**.
- 2 Use the scroll key to see the entire mail.
- 3 To reply to or forward a mail, select **Options**.

View and save attachments

Mails with attachments, for example, pictures, are marked with a paperclip icon. Some attachments may not be compatible with your device, and cannot be displayed on your device.

- 1 Expand the attachment list.
- 2 Select an attachment and **View**.
- 3 To save the attachment to your device, select **Save**.

Create and send a mail

- 1 Select **Options** > **Compose**.
- 2 Enter the recipient's mail address, the subject, and your message.
- 3 To attach a file to the mail, select **Options** > **Attach file**.

- 4 To capture an image to attach to the mail, select **Options** > **Attach new image**.
- 5 To send the mail, select **Send**.

Close the mail application

Select **Sign Out**.

Access IM from your mail account

Some mail service providers allow you to access your instant messaging account directly from your mail account.

To sign in to your provider's instant messaging service when writing a mail, select **Options** and your IM service.

Image and video

Capture images

Activate the camera

Select **Menu** > **Media** > **Camera**; or, if in video mode, scroll left or right.

Zoom in or out

In image mode, scroll up and down, or use the volume keys.

Capture an image

Your device has an auto focus camera. Select **Capture**. Release the key to capture the image.

Images are saved in Gallery.

Activate the camera flash

To set the device to use the flash automatically if the lighting conditions require it, select **Options** > **Flash** > **Automatic**. To set the device to always use the flash, select **Flash on**.

Keep a safe distance when using the flash. Do not use the flash on people or animals at close range. Do not cover the flash while taking a picture.

Display images after capture

Select **Options** > **Settings** > **Photo preview time** and the preview time.

End the image preview manually

Select **Back**.

Your device supports an image capture resolution of 1536x2048 pixels.

Record video clips

Activate video mode

Select **Menu** > **Media** and **Video camera**, or, if in image mode, scroll left or right.

Start recording

Select **Record**.

Pause or resume recording

Select **Pause** or **Continue**.

Stop recording

Select **Stop**.

Video clips are saved in Gallery.

Camera and video settings

Select **Menu** > **Media** > **Camera**.

In image or video mode, select **Options** and from the following:

Settings — Modify other camera and video settings, and select where to save images and video clips.

Self-timer — Use the self-timer.

Effects — Apply different effects (for example, greyscale and false colour) to the captured image.

White balance — Adapt the camera to the current light conditions.

Landscape format or **Portrait format** — Select the orientation of the camera.

Gallery

Manage images, video clips, music files, themes, graphics, tones, recordings, and received files. These files are stored in the device memory or on a memory card and may be arranged in folders.

Photos

View images and play video clips with the Photos application.

Select **Menu** > **Gallery** > **Photos**.

Select from the following:

All photos — View images in a thumbnail grid. You can sort images by date, name, or size.

Timeline — View images in the order they were captured.

Albums — Sort images into albums. You can create, rename and remove albums. If you remove an album, the images inside the album are not deleted from the memory.

View a slide show

A slide show uses the images of the currently selected folder or album.

- 1 Select **All photos**, **Timeline**, or **Albums**.
- 2 Select **Options** > **Slide show**.

- 3 Select **Start slide show**.

Edit images

You can, for example, rotate, flip, crop, and adjust the brightness, contrast, and colours of images.

- 1 Select an image in **All photos**, **Timeline**, or **Albums**.
- 2 Select **Options** > **Edit photo**.
- 3 Select an editing option, and use the scroll key to change the settings or values.

Music and videos

Your device includes a media player for playing songs and video clips. Music and video files stored in the music folder in the device memory or on the memory card are automatically detected and added to the video or music library.

Select **Menu** > **Gallery** and **Music & videos**.

Select from the following:

Videos — List all available video clips.

All songs — List all available songs. You can sort songs by artist, album, or genre, for example.

Manage folders and files

To manage folders and files in Gallery, select **Menu > Gallery**.

View a list of folders

Select **All content**.

View a list of files in a folder

Select a folder and **Open**.

View the folders of the memory card when moving a file

Scroll to the memory card, and scroll right.

Print images

Your device supports Nokia XpressPrint, allowing you to print images in the JPEG file format.

- 1 Connect your device to a compatible printer, using a USB data cable, or, if supported by the printer, Bluetooth connectivity.
- 2 Select an image from Gallery and **Options > Print**.

Memory card

Use a memory card to store your multimedia files, such as video clips, songs, sound files, images, and messaging data.

Select **Menu > Gallery > All content > Memory card**.

Some of the folders in Gallery that contain content used by your device (for example, Themes) can be stored on the memory card.

If your memory card has not been pre-formatted, you need to format it. When you format a memory card, all data on the card is permanently deleted.

Format the memory card

Select **Options > Mem. card options > Format memory card > Yes**. When formatting is complete, enter a name for the memory card.

Protect the memory card with a password

Select **Options > Mem. card options > Set password**. The password is stored in your device, so you only have to enter the password when attempting to use the memory card in another device.

Remove the memory card password

Select **Options > Mem. card options > Delete password**.

Check the memory consumption

Select **Options > Details**. The memory consumption of different data groups, and the amount of available memory to install new software, is displayed.

Entertainment

Listen to music

Listen to music with the music player or radio, and record sounds or voice with the voice recorder. Download music from the internet, or transfer music from your PC.

Media player

To open the media player, select **Menu > Media > Media player**.

Music menu

Access your music and video files stored in the device memory or on the memory card, download music or video clips from the web, or view compatible video streams from a network server (network service).

Select **Menu > Media > Media player**.

Play a media file

Select a file from the available folders and **Play**.

Download files from the web

Select **Options > Downloads** and a download site.

Update the music library after adding files

Select **Options > Update library**.

Create a playlist

- 1 Select **Playlists > Create playlist**, and enter the name of the playlist.
- 2 Add music or video clips from the displayed lists.
- 3 To store the playlist, select **Done**.

Configure a streaming service

You may receive the streaming settings as a configuration message from the service provider. You can also enter the settings manually.



- 1 Select **Options > Downloads > Streaming settings > Configuration**.
- 2 Select a service provider, **Default**, or **Personal config**. for streaming.
- 3 Select **Account** and a streaming service account from the active configuration settings.

Play songs

To adjust the volume level, press the volume keys.

Operate the player with the music player keys or similarly with the virtual keys on the display.

To start or pause playing, press .

To skip to the next song, press . To skip to the beginning of the previous song, press  twice.

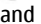
To fast-forward the current song, press and hold . To rewind the current song, press and hold . Release the key at the position you want to continue the music playback.

In the media player menu, you can use the following shortcuts:

To switch to the music menu, select



To switch to the current playlist, select .

To close the media player menu, and to continue music playback in the background, press the end key.

To stop the media player, press and hold the end key.

Change the media player look

Your phone provides several themes to change the look of the media player.

Select **Menu > Media > Media player > Go to Media player > Options > Settings > Media player theme** and one of the listed themes. The virtual keys may change depending on the theme.

Radio

Your device has an integrated FM antenna.

Select **Menu > Media > Radio**.

Tune in to radio stations

- 1 To start the search, press and hold the scroll key left or right. To change the radio frequency in 0.05 MHz steps, briefly press the scroll key left or right.
- 2 To save a station to a memory location, select **Options > Save station**.
- 3 To enter the name of the radio station, select **Options > Stations > Options > Rename**.

Select **Options** and from the following:

Search all stations — Search automatically for the available stations at your location.

Set frequency — Enter the frequency of a radio station.

Station directory — Access a website with a list of radio stations.

Stations — List, rename, or delete saved stations.

Use the virtual keys on the display

Use the scroll key.

Change stations

Scroll up or down, or press the number key that corresponds to the number of the station in the station list.

Adjust the volume

Use the volume keys.

Set the radio to play in the background

Briefly press the end key.

Close the radio

Press and hold the end key.

Radio settings

Select **Menu** > **Media** > **Radio**.

Select **Options** > **Settings** and from the following:

RDS — Display information from the radio data system, such as the name of the station.

Auto-frequency — Allow the device to automatically switch to a frequency with better reception (available when RDS is activated).

Play via — Listen using the headset or the loudspeaker.

Output — Switch between stereo and mono output.

Radio theme — Select the look of the radio.



Touch music keys — Activate the touch music keys.

Voice recorder

Record speech, sound, or an active call, and save the recordings in Gallery.

Select **Menu** > **Media** > **Voice recorder**.

The recorder cannot be used when a data call or GPRS connection is active.

To use the graphical keys , , or , scroll left or right.

Start recording

Select , or, during a call, select **Options** > **Record**. While recording a call, all parties to the call hear a faint beeping.

Pause recording

Select .

Stop recording

Select . The recording is saved in the Recordings folder in Gallery.

To play or send the last recording, to access the list of recordings, or to select the memory and the folder to store the recordings, select **Options** and the appropriate option.

Equaliser

Adjust the sound when using the music player.

Select **Menu** > **Media** > **Equaliser**.

To activate a predefined equaliser set, scroll to one of the sets, and select **Activate**.

Create a new equaliser set

- 1 Select one of the last two sets in the list and **Options** > **Edit**.

- 2 Scroll left or right to access the virtual sliders and up or down to adjust the slider.
- 3 To save the settings and create a name for the set, select **Save** and **Options** > **Rename**.

Web

You can access various internet services with your device browser (network service). The appearance of the internet pages may vary due to screen size. You may not be able to see all the details on the internet pages.

Important: Use only services that you trust and that offer adequate security and protection against harmful software.

For the availability of these services, pricing, and instructions, contact your service provider.

You may receive the configuration settings required for browsing as a configuration message from your service provider.

To set up the service, select **Menu** > **Internet** > **Web settings** > **Configuration sett.**, a configuration, and an account.

Connect to a service

To make a connection to the service, select **Menu > Internet > Home**; or in the standby mode, press and hold **0**.

To select a bookmark, select **Menu > Internet > Bookmarks**.

To select the last visited URL, select **Menu > Internet > Last web addr..**

To enter the address of a service, select **Menu > Internet > Go to address**. Enter the address, and select **OK**.

After you make a connection to the service, you can start browsing its pages. The function of the phone keys may vary in different services. Follow the text guides on the phone display. For more information, contact your service provider.

Web uploads

Open the web page of your online sharing service to view uploaded images and videos and to change settings (network service).

Open an online sharing service

- 1 Select **Menu > Internet > Web uploads** and an online sharing service.

- 2 Select from the links offered by the service.

Change settings of an online sharing service

- 1 Select **Menu > Internet > Web uploads** and an online sharing service.
- 2 Select **Options > Settings** to open the settings page of the service.

Appearance settings

While browsing the web, select **Options > Settings** and from the following:

Display — Select the font size, whether images are shown, and how the text is displayed.

General — Select whether web addresses are sent as Unicode (UTF-8), the encoding type for the contents, and whether JavaScript™ is enabled.

The available options may vary.

Cache memory

A cache is a memory location that is used to store data temporarily. If you have tried to access or have accessed confidential information requiring passwords, empty the cache after each use. The information or services you have accessed are stored in the cache.

A cookie is data that a site saves in the cache memory of your phone. Cookies are saved until you clear the cache memory.

To clear the cache while browsing, select **Options > Tools > Clear the cache**.

To allow or prevent the phone from receiving cookies, select **Menu > Internet > Web settings > Security > Cookies**; or, while browsing, select **Options > Settings > Security > Cookies**.

Browser security

Security features may be required for some services, such as banking services or online shopping. For such connections you need security certificates and possibly a security module, which may be available on your SIM card. For more information, contact your service provider.

To view or change the security module settings, or to view a list of authority or user certificates downloaded to your device, select **Menu > Settings > Security > Security module sett., Authority certificates, or User certificates**.

Important: Even if the use of certificates makes the risks involved in remote connections and software installation considerably smaller, they must be used correctly in order to benefit from increased security. The existence of a certificate does not offer any protection by itself; the certificate manager must contain correct, authentic, or trusted certificates for increased security to be available. Certificates have a restricted lifetime. If "Expired certificate" or "Certificate not valid yet" is shown, even if the certificate should be valid, check that the current date and time in your device are correct.

Before changing any certificate settings, you must make sure that you really trust the owner of the certificate and that the certificate really belongs to the listed owner.

Games and applications

You can manage applications and games. Your phone may have some games or applications installed. These files are stored in the phone memory or an attached memory card and may be arranged in folders.

Launch an application

Select **Menu > Applications > Games, Collection, or Memory card**. Scroll to a game or an application, and select **Open**.

To set sounds, lights, and shakes for a game, select **Menu > Applications > Options > Application settings**.

To view application options, select **Menu > Applications > Collection > Options**.

Select from the following:

Update version — Check if a new version of the application is available for download from the web (network service).

Web page — Obtain further information or additional data for the application from an internet page (network service), if available.

Application access — Restrict the application from accessing the network.

The available options may vary.

Download an application

Your phone supports J2ME™ Java applications. Ensure that the application is compatible with your phone before downloading it.

Important: Only install and use applications and other software from trusted sources, such as applications that are Symbian Signed or have passed the Java Verified™ testing.

You can download new applications and games in different ways.

- Select **Menu > Applications > Options > Downloads > App. downloads or Game downloads**; the list of available bookmarks is shown.
- Use the Nokia Application Installer from PC Suite to download the applications to your phone.

For the availability of different services and pricing, contact your service provider.

Mobile TV

About Mobile TV

Your device has an integrated Digital Video Broadcast - Handheld (DVB-H) receiver, which enables it to receive digital TV broadcasts. With Mobile TV, you can access mobile television and watch and listen to digital TV programmes.

You can receive calls in the normal way while watching Mobile TV.

You cannot watch Mobile TV when in Flight mode.

You require a GPRS connection to be able to use the Mobile TV application. Data transfer charges may apply. For more information, contact your service provider.

If you do not have access to a Mobile TV service, the operators in your area may not support Mobile TV services.

Mobile TV services may only be available upon subscription. For the Mobile TV network coverage, availability and pricing of Mobile TV services, and instructions on accessing the services, contact your service provider.

In some countries, owners of a television receiver are required to pay a television licence fee. For more information, contact your local authorities.

Initial start-up

Select **Menu > Mobile TV**. The device scans for available channels. This may take a few minutes.

During the device scan, you may be prompted to select a **Programme guide**, provided by the network operator. To select a **Programme guide**, scroll to an item, and choose **Select**.

The network operator may provide more than one **Programme guide**. To change the **Programme guide**, select **Options > Organise > Delete all channels**, and follow the instructions.

The next time you open Mobile TV, the last selected **Programme guide** and the last watched TV channel are displayed. If the device can not find any TV channels, there may not be TV coverage available.

To search for available channels, select **Options > Scan**.

Select a channel or programme

You may have to subscribe to a channel before you can watch it. See "[Subscribe to a channel](#)", p. 46.

To change the channel, use the scroll key. Alternatively, use the music touch keys, and select **⏮**, **⏭**, or **⏸**.

Select a channel from the list. Alternatively, use the number keys to enter a channel number.

To change the order of the channels, select **Options > Organise**.

To navigate the program listings in the **Programme guide**, use the scroll key.

To adjust the volume, use the volume keys. To mute or unmute the sound, press **#**.

For your safety, when Mobile TV opens, the volume level is low.

Change audio output

To switch the audio output between the headset and loudspeaker, select **Options > Audio via loudsp.** or **Audio via headset**.

Electronic Programme Guide (EPG)

To view the Electronic Programme Guide (EPG), press the scroll key, and select **EPG**.

To view a programme that is currently being broadcast on an unencrypted channel, choose **Select** twice. Programmes are arranged according to their start times.

If the selected channel is encrypted, a purchase prompt is displayed.

To exit the EPG, press the right selection key.

Programme guides are provided by the network operator. More than one **Programme guide** may be available.

[See "Initial start-up", p. 45.](#)

Subscribe to a channel

Some TV channels may require you to purchase a subscription. You can purchase a single channel or channel package. Both are available for a fixed time period or automatically renewed duration.

To purchase a channel or channel package, you require a SIM card in your device, and network coverage availability.

View your purchased subscriptions

Select **Options > Subscriptions > Expiring or Continuous**.

To unsubscribe, select **Details**. If it is not possible to unsubscribe, for further details and support, contact your service provider.

If you try to access an encrypted channel, you are advised how to purchase a subscription.

Purchase from the channel list

- 1 To view available items, press the scroll key.

- 2 Select an item from the list.
- 3 To purchase an item, press the scroll key again.
- 4 To confirm your purchase, accept the disclaimer, and follow the instructions.

Your device must be connected to an available service network to acquire the rights to watch the purchased media.

Purchase from the EPG

- 1 In the detailed view of the EPG, select an item from the list.
- 2 To purchase a channel or channel package, press the scroll key.
- 3 To confirm your purchase, accept the disclaimer, and follow the instructions.

Purchase from the options menu

- 1 Select an item from the list.
- 2 To purchase a channel or channel package, select **Options** > **Subscriptions** > **Purchase**.
- 3 To confirm your purchase, accept the disclaimer, and follow the instructions.

Mobile TV settings

Select **Options** > **Settings** and from the following:

Clock — Hide or display the clock.

Illumination — Set the display brightness level.

Allow net. acc. — Select the level of network access for purchasing new channels.

Touch keys — Enable or disable the use of music keys.

Parental control — Modify the age restriction settings. A security code is required. Contact your network operator for further information.

The available options may vary.

Access Mobile TV after changing SIM card

All Mobile TV subscriptions are connected to the SIM card in your device.

Your device detects when a new SIM card has been inserted.

Changing the SIM card will delete all TV stations and subscriptions from your device.

To access your previous subscriptions, insert the original SIM card. Then, select **Options** > **Subscriptions** > **Retrieve**.

Maps

You can browse maps for different cities and countries, search for addresses and points of interest, plan routes from one location to another, save locations as landmarks, and send them to compatible devices.

Almost all digital cartography is inaccurate and incomplete to some extent. Never rely solely on the cartography that you download for use in this device.

Note: Downloading content such as maps, satellite images, voice files, guides or traffic information may involve transmission of large amounts of data (network service).

Content such as satellite images, guides, weather and traffic information and related services are generated by third parties independent of Nokia. The content may be inaccurate and incomplete to some extent and is subject to availability. Never rely solely on the aforementioned content and related services.

Find detailed information about Maps on www.nokia.com/maps.

To use the Maps application, select **Menu > Organiser > Maps** and from the available options.

Download maps

Your device may contain pre-installed maps on the memory card. You can download a new set of maps through the internet using the Nokia Map Loader PC software.

Download and install Nokia Map Loader

- 1 To download the Nokia Map Loader on your PC and for further instructions, visit www.maps.nokia.com.
- 2 Select **Menu > Organiser > Maps** to do an initial configuration.

Download maps

Before you download new maps for the first time, ensure that you have a memory card inserted in the device.

To change the selection of maps on your memory card, use the Nokia Map Loader to delete all maps on the memory card and download a new selection, to ensure that all maps are from the same release.

Download maps automatically

Select **Menu > Organiser > Maps and Settings > Network settings > Allow network usage > Yes or In home network.**

Deactivate automatic download

Select **No.**

Note: Downloading content such as maps, satellite images, voice files, guides or traffic information may involve transmission of large amounts of data (network service).

Maps and GPS

Your device does not have an internal GPS antenna. To use applications that require a GPS connection, use a compatible external GPS receiver (accessory sold separately). Pair the GPS receiver with your device using Bluetooth wireless technology. For more information, see the user guide of the GPS receiver.

After pairing your device with an external GPS receiver, it may take several minutes for the device to display the current location.

The Global Positioning System (GPS) is operated by the government of the

United States, which is solely responsible for its accuracy and maintenance. The accuracy of location data can be affected by adjustments to GPS satellites made by the United States government and is subject to change with the United States Department of Defense civil GPS policy and the Federal Radionavigation Plan. Accuracy can also be affected by poor satellite geometry. Availability and quality of GPS signals may be affected by your location, buildings, natural obstacles, and weather conditions. GPS signals may not be available inside buildings or underground and may be impaired by materials such as concrete and metal.

GPS should not be used for precise location measurement, and you should never rely solely on location data from the GPS receiver and cellular radio networks for positioning or navigation.

Extra services

You can upgrade Maps to a full navigation system to be used by car and by foot. You need a regional licence for the full navigation system. The car navigation is fully voice-guided with two- and three-dimensional map views. The pedestrian navigation is limited to a speed of 30 km/h (18.6 miles/h) and provides no voice guidance. The

navigation service is not available for all countries and regions. For details, see your local Nokia website.

To use this service, you need a compatible external GPS receiver that supports Bluetooth wireless technology.

Purchase a navigation service

Select **Menu > Organiser > Maps and Extra services > Purchase nav. licence**, and follow the instructions.

To use navigation with voice guidance, you must allow the Maps application to use a network connection.

The navigation licence is connected to your SIM card. If you insert another SIM card in your device, you are asked to purchase a licence when starting navigation. During the purchase procedure, you are offered to transfer the existing navigation licence to the new SIM card without extra charge.

Organise

Let your phone help you to organise your life.

Manage contacts

Save names, phone numbers, and addresses as contacts in the device and on the SIM card.

Select **Menu > Contacts**.

Select the memory for contacts

The device memory can save contacts with additional details, such as various phone numbers and text items. You can also save an image, a tone, or a video clip for a limited number of contacts.

The SIM card memory can save names with one phone number attached to them. The contacts saved in the SIM card memory are indicated with .

- 1 Select **Settings > Memory in use** to select the SIM card, the device memory, or both for your contacts.
- 2 Select **Phone and SIM** to recall contacts from both memories. When you save contacts, they are saved in the device memory.

Handle contacts

Search for a contact

Select **Menu > Contacts > Names**.

Scroll through the list of contacts, or enter the first characters of the contact's name.

Save a name and phone number

Select **Menu** > **Contacts** > **Add new**.

Add or edit a detail

Select a contact and **Details** > **Options** > **Add detail**.

Delete a detail

Select a contact and **Details**. Select a detail and **Options** > **Delete**.

Delete a contact

Select a contact and **Options** > **Delete contact**.

Delete all contacts

Select **Menu** > **Contacts** > **Del. all contacts** > **From phone memory** or **From SIM card**.

Copy or move contacts between the device and SIM card memories

Copy single contacts

Select **Options** > **Marking options** > **Mark**. Mark the contacts you want to copy or move, and select **Options** > **Copy marked** or **Move marked**.

Copy all contacts

Select **Menu** > **Contacts** > **Copy contacts** or **Move contacts**.

Create a contact group

Arrange contacts into caller groups with different ringing tones and group images.

- 1 Select **Menu** > **Contacts** > **Groups**.
- 2 Select **Add or Options** > **Add new group** to create a new group.
- 3 Enter the group name, optionally select an image and a ringing tone, and select **Save**.
- 4 To add contacts to the group, select the group and **View** > **Add**.

Business cards

You can send and receive a person's contact information from a compatible device that supports the vCard standard.

To send a business card, search for the contact, and select **Details** > **Options** > **Send business card**.

When you receive a business card, select **Show** > **Save** to save the business card in the phone memory.

Date and time

To change the clock type, time, time zone, or date, select **Menu** > **Settings** > **Date and time**.

When travelling to a different time zone, select **Menu** > **Settings** > **Date and time** > **Date & time settings** > **Time zone:**, and scroll left or right to select the time zone of your location. The time and date are set according to the time zone and enable your phone to display the correct sending time of received text or multimedia messages.

For example, GMT -5 denotes the time zone for New York (USA), 5 hours west of Greenwich, London (UK).

Alarm clock

To sound an alarm at a desired time.

Set the alarm

- 1 Select **Menu** > **Organiser** > **Alarm clock**.
- 2 Activate the alarm, and enter the alarm time.
- 3 To repeat the alarm on selected days of the week, select **Repeat:** > **On** and the days.
- 4 Select the alarm tone.
- 5 Define the snooze time-out period, and select **Save**.

Stop the alarm

To stop the sounding alarm, select **Stop**.

If you let the alarm sound for a minute or select **Snooze**, the alarm stops for the snooze time-out period, then resumes.

Calendar

Select **Menu** > **Organiser** > **Calendar**.

The current day is framed. If there are any notes set for the day, the day is displayed in bold. To view the day notes, select **View**. To view a week, select **Options** > **Week view**.

To modify date and time settings, select **Options** > **Settings**. To delete old notes automatically after a specified time, select **Options** > **Settings** > **Auto-delete notes**.

Add a calendar note

Scroll to the date, and select **Options** > **Make a note**. Select the note type, and enter the details in the fields.

To-do list

To create a note for a task that you must do, select **Menu** > **Organiser** > **To-do list**.

To create a note if no note is added, select **Add**; otherwise, select **Options > Add**. Fill in the fields, and select **Save**.

To view a note, scroll to it, and select **View**.

Notes

To write and send notes, select **Menu > Organiser > Notes**.

To make a note if no note is added, select **Add**; otherwise, select **Options > Make a note**. Write the note, and select **Save**.

Calculator

Your phone provides a standard, a scientific, and a loan calculator.

Select **Menu > Organiser > Calculator**, the calculator type, and the operating instructions.

This calculator has limited accuracy and is designed for simple calculations.

Countdown timer

Normal timer

- 1 To activate the timer, select **Menu > Organiser > Countd. timer > Normal timer**, enter a time, and write a note that is

displayed when the time expires. To change the time, select **Change time**.

- 2 To start the timer, select **Start**.
- 3 To stop the timer, select **Stop timer**.

Interval timer

- 1 To have an interval timer with up to 10 intervals started, first enter the intervals.
- 2 Select **Menu > Organiser > Countd. timer > Interval timer**.
- 3 To start the timer, select **Start timer > Start**.

To select how the interval timer should start the next period, select **Menu > Organiser > Countd. timer > Settings > Contin. to next period**.

Stopwatch

You can measure time, take intermediate times, or take lap times using the stopwatch.

Select **Menu > Organiser > Stopwatch** and from the following:

Split timing — to take intermediate times. To reset the time without saving it, select **Options > Reset**.

Lap timing — to take lap times

Continue — to view the timing that you have set in the background. To set the stopwatch timing in the background, press the end key.

Show last — to view the most recently measured time if the stopwatch is not reset

View times or **Delete times** — to view or delete the saved times

To set the stopwatch timing in the background, press the end key.

Support and updates

Nokia helps you in many ways to gain the most benefit from your device.

Support

When you want to learn more about how to use your product or you are unsure how your device should function, see the user guide or see the support pages at www.nokia.com/support or your local Nokia website, or with a mobile device, www.nokia.mobi/support.

If this does not resolve your issue, do the following:

- Restart the device: switch off the device, and remove the battery.

After about a minute, replace the battery, and switch on the device.

- With the Nokia Software Updater application, update your device software regularly for optimum performance and possible new features. See www.nokia.com/softwareupdate or your local Nokia website. Remember to back up your device data before updating the device software.
- Restore the original factory settings as explained in the user guide.

If the issue remains unsolved, contact Nokia for repair options. See www.nokia.com/repair. Before sending your device for repair, always back up the data in your device.

My Nokia

Receive free tips, tricks, and support for your Nokia phone, plus free trial content, interactive demonstrations, a personalised web page, and news about the latest Nokia products and services.

Get the most out of your Nokia phone and register at My Nokia today! For more information and availability in your region, see www.nokia.com/mynokia.

Download content

You may be able to download new content (for example, themes) to your phone (network service).

Important: Use only services that you trust and that offer adequate security and protection against harmful software.

For the availability of different services and pricing, contact your service provider.

Update software using your PC

Nokia Software Updater is a PC application that enables you to update your device software. To update your device software, you need a compatible PC, broadband internet access, and a compatible USB data cable to connect your device to the PC.

To get more information and to download the Nokia Software Updater application, go to www.nokia.com/softwareupdate.

Software updates over the air

Your service provider may send phone software updates over the air directly to your phone (network service). This option may not be available, depending on your phone.

Downloading software updates may involve the transmission of large amounts of data (network service).

Make sure that the device battery has enough power, or connect the charger before starting the update.

Warning:

If you install a software update, you cannot use the device, even to make emergency calls, until the installation is completed and the device is restarted. Be sure to back up data before accepting installation of an update.

Software update settings

This option may not be available, depending on your phone.

To allow or disallow software and configuration updates, select **Menu > Settings > Configuration > Device manager sett. > Serv. softw. updates**.

Request a software update

- 1 Select **Menu > Settings > Phone > Phone updates** to request available software updates from your service provider.
- 2 Select **Current softw. details** to display the current software version

and check whether an update is needed.

- 3 Select **Downl. phone softw.** to download and install a software update. Follow the instructions on the display.
- 4 If the installation was cancelled after the download, select **Install softw. update** to start the installation.

The software update may take several minutes. If there are problems with the installation, contact your service provider.

Restore factory settings

To restore the phone back to factory conditions, select **Menu > Settings > Rest. factory sett.** and from the following:

Restore settings only — Reset all preference settings without deleting any personal data.

Restore all — Reset all preference settings and delete all personal data, such as contacts, messages, media files, and activation keys.

Green tips



Here are tips on how you can contribute to protecting the environment.

Save energy

When you have fully charged the battery and disconnected the charger from the device, unplug the charger from the wall outlet.

You do not need to charge your battery so often if you do the following:

- Close and disable applications, services, and connections when not in use.
- Decrease the brightness of the screen.
- Set the device to enter the power saver mode after the minimum period of inactivity, if available in your device.
- Disable unnecessary sounds, such as keypad and ringing tones.

Recycle

Most of the materials in a Nokia phone are recyclable. Check how to recycle your Nokia products at www.nokia.com/werecycle, or with a mobile device, www.nokia.mobi/werecycle.

Recycle packaging and user guides at your local recycling scheme.

Learn more

For more information on the environmental attributes of your device, see www.nokia.com/ecodeclaration.

Product and safety information

Digital rights management

Content owners may use different types of digital rights management (DRM) technologies to protect their intellectual property, including copyrights. This device uses various types of DRM software to access DRM-protected content. With this device you can access content protected with WMDRM 10, OMA DRM 1.0, OMA DRM 1.0 forward lock, and OMA DRM 2.0. If certain DRM software fails to protect the content, content owners may ask that such DRM software's ability to access new DRM-protected content be revoked. Revocation may also prevent renewal of such DRM-protected content already in your device. Revocation of such DRM software does not affect the use of content protected with other types of DRM or the use of non-DRM-protected content.

Digital rights management (DRM) protected content comes with an associated licence that defines your rights to use the content.

If your device has OMA DRM-protected content, to back up both the licence and the content, use the backup feature of Nokia PC Suite.

Other transfer methods may not transfer the licence which need to be restored with the content for you to be able to continue the use of OMA DRM-protected content after the device memory is formatted. You may also need to restore the licence in case the files on your device get corrupted.

If your device has WMDRM-protected content, both the licence and the content will be lost if the device memory is formatted. You may also lose the licence and the content if the files on your device get corrupted. Losing the licence or the content may limit your ability to use the same content on your device again. For more information, contact your service provider.

Some licence may be connected to a specific SIM card, and the protected content can be accessed only if the SIM card is inserted in the device.

Third-party applications

The third-party applications provided with your device may have been created and may be owned by persons or entities not affiliated with or related to Nokia. Nokia does not own the copyrights or intellectual property rights to the third-party applications. As such, Nokia does not take any responsibility for end-user support, functionality of the applications, or the information in the applications or these materials. Nokia does not provide any warranty for the third-party applications.

BY USING THE APPLICATIONS YOU ACKNOWLEDGE THAT THE APPLICATIONS ARE PROVIDED AS IS WITHOUT WARRANTY OF ANY KIND, EXPRESS OR IMPLIED, TO THE MAXIMUM EXTENT PERMITTED BY APPLICABLE LAW. YOU FURTHER ACKNOWLEDGE THAT NEITHER NOKIA NOR ITS AFFILIATES MAKE ANY REPRESENTATIONS OR WARRANTIES, EXPRESS OR

58 Product and safety information

IMPLIED, INCLUDING BUT NOT LIMITED TO WARRANTIES OF TITLE, MERCHANTABILITY OR FITNESS FOR A PARTICULAR PURPOSE, OR THAT THE APPLICATIONS WILL NOT INFRINGE ANY THIRD-PARTY PATENTS, COPYRIGHTS, TRADEMARKS, OR OTHER RIGHTS.

Accessories

Warning:

Use only batteries, chargers, and accessories approved by Nokia for use with this particular model. The use of any other types may invalidate any approval or warranty, and may be dangerous. In particular, use of unapproved chargers or batteries may present a risk of fire, explosion, leakage, or other hazard.

For availability of approved accessories, please check with your dealer. When you disconnect the power cord of any accessory, grasp and pull the plug, not the cord.

Battery

Battery and charger information

Your device is powered by a rechargeable battery. The battery intended for use with this device is BL-4U. Nokia may make additional battery models available for this device. This device is intended for use when supplied with power from the following chargers: AC-8. The exact charger model number may vary depending on the type of plug. The plug variant is identified by one of the following: E, EB, X, AR, U, A, C, K, or UB.

The battery can be charged and discharged hundreds of times, but it will eventually wear out. When the talk and standby times are noticeably shorter than normal, replace the battery. Use only Nokia approved batteries, and recharge your battery only with Nokia approved chargers designated for this device.

If a battery is being used for the first time or if the battery has not been used for a prolonged period, it may be necessary to connect the charger, then disconnect and

reconnect it to begin charging the battery. If the battery is completely discharged, it may take several minutes before the charging indicator appears on the display or before any calls can be made.

Safe removal. Always switch the device off and disconnect the charger before removing the battery.

Proper charging. Unplug the charger from the electrical plug and the device when not in use. Do not leave a fully charged battery connected to a charger, since overcharging may shorten its lifetime. If left unused, a fully charged battery will lose its charge over time.

Avoid extreme temperatures. Always try to keep the battery between 15°C and 25°C (59°F and 77°F). Extreme temperatures reduce the capacity and lifetime of the battery. A device with a hot or cold battery may not work temporarily. Battery performance is particularly limited in temperatures well below freezing.

Do not short-circuit. Accidental short-circuiting can occur when a metallic object such as a coin, clip, or pen causes direct connection of the positive (+) and negative (-) terminals of the battery. (These look like metal strips on the battery.) This might happen, for example, when you carry a spare battery in your pocket or purse. Short-circuiting the terminals may damage the battery or the connecting object.

Disposal. Do not dispose of batteries in a fire as they may explode. Dispose of batteries according to local regulations. Please recycle when possible. Do not dispose as household waste.

Leak. Do not dismantle, cut, open, crush, bend, puncture, or shred cells or batteries. In the event of a battery leak, prevent battery liquid contact with skin or eyes. If this happens, flush the affected areas immediately with water, or seek medical help.

Damage. Do not modify, remanufacture, attempt to insert foreign objects into the battery, or immerse or expose it

to water or other liquids. Batteries may explode if damaged.

Correct use. Use the battery only for its intended purpose. Improper battery use may result in a fire, explosion, or other hazard. If the device or battery is dropped, especially on a hard surface, and you believe the battery has been damaged, take it to a service centre for inspection before continuing to use it. Never use any charger or battery that is damaged. Keep your battery out of the reach of small children.

Nokia battery authentication guidelines

Always use original Nokia batteries for your safety. To check that you are getting an original Nokia battery, purchase it from a Nokia authorised service centre or dealer, and inspect the hologram label using the following steps:

Authenticate hologram

- 1 When you look at the hologram on the label, you should see the Nokia connecting hands symbol from one angle and the Nokia Original Enhancements logo when looking from another angle.



- 2 When you angle the hologram left, right, down and up, you should see 1, 2, 3 and 4 dots on each side respectively.



Successful completion of the steps is not a total assurance of the authenticity of the battery. If you cannot confirm authenticity or if you have any reason to believe that your Nokia battery with the hologram on the label is not an authentic Nokia battery, you should refrain from using it, and take it to the nearest Nokia authorised service centre or dealer for assistance.

To find out more about original Nokia batteries, see www.nokia.com/battery.

Taking care of your device

Your device is a product of superior design and craftsmanship and should be treated with care. The following suggestions will help you protect your warranty coverage.

- Keep the device dry. Precipitation, humidity, and all types of liquids or moisture can contain minerals that will corrode electronic circuits. If your device does get wet, remove the battery, and allow the device to dry completely before replacing it.
- Do not use or store the device in dusty, dirty areas. Its moving parts and electronic components can be damaged.

- Do not store the device in high or cold temperature. High temperatures can shorten the life of electronic devices, damage batteries, and warp or melt certain plastics. When the device warms to its normal temperature from a cold temperature, moisture can form inside the device and damage electronic circuit boards.
- Do not attempt to open the device other than as instructed in this guide.
- Do not drop, knock, or shake the device. Rough handling can break internal circuit boards and fine mechanics.
- Do not use harsh chemicals, cleaning solvents, or strong detergents to clean the device. Only use a soft, clean, dry cloth to clean the surface of the device.
- Do not paint the device. Paint can clog the moving parts and prevent proper operation.
- Use only the supplied or an approved replacement antenna. Unauthorised antennas, modifications, or attachments could damage the device and may violate regulations governing radio devices.
- Use chargers indoors.
- Backup all data you want to keep, such as contacts and calendar notes.
- To reset the device from time to time for optimum performance, power off the device and remove the battery.

These suggestions apply equally to your device, battery, charger, or any accessory.

Recycle

Always return your used electronic products, batteries, and packaging materials to dedicated collection points. This way you help prevent uncontrolled waste disposal and promote the recycling of materials. Check product environmental information and how to recycle your Nokia products at www.nokia.com/werecycle, or nokia.mobi/werecycle.



The crossed-out wheeled-bin symbol on your product, battery, literature, or packaging reminds you that all electrical and electronic products, batteries, and accumulators must be taken to separate collection at the end of their working life. This requirement applies in the European Union. Do not dispose of these products as unsorted municipal waste. For more environmental information, see the product Eco-Declarations at www.nokia.com/environment.

Additional safety information Magnets and magnetic fields

Keep your device away from magnets or magnetic fields.

Small children

Your device and its accessories are not toys. They may contain small parts. Keep them out of the reach of small children.

Operating environment

This device meets RF exposure guidelines in the normal use position at the ear or at least 1.5 centimetre (5/8 inch) away from the body. Any carry case, belt clip, or holder for body-worn operation should not contain metal and should position the device the above-stated distance from your body.

To send data files or messages requires a quality connection to the network. Data files or messages may be delayed until such a connection is available. Follow the separation distance instructions until the transmission is completed.

Medical devices

Operation of radio transmitting equipment, including wireless phones, may interfere with the function of inadequately protected medical devices. Consult a

physician or the manufacturer of the medical device to determine whether they are adequately shielded from external RF energy. Switch off your device when regulations posted instruct you to do so. Hospitals or health care facilities may use equipment sensitive to external RF energy.

Implanted medical devices

Manufacturers of medical devices recommend a minimum separation of 15.3 centimetres (6 inches) between a wireless device and an implanted medical device, such as a pacemaker or implanted cardioverter defibrillator, to avoid potential interference with the medical device. Persons who have such devices should:

- Always keep the wireless device more than 15.3 centimetres (6 inches) from the medical device.
- Not carry the wireless device in a breast pocket.
- Hold the wireless device to the ear opposite the medical device.
- Turn the wireless device off if there is any reason to suspect that interference is taking place.
- Follow the manufacturer directions for the implanted medical device.

If you have any questions about using your wireless device with an implanted medical device, consult your health care provider.

Hearing aids

Some digital wireless devices may interfere with some hearing aids.

Vehicles

RF signals may affect improperly installed or inadequately shielded electronic systems in motor vehicles such as electronic fuel injection, electronic antilock braking, electronic speed control, and air bag systems. For more information, check with the manufacturer of your vehicle or its equipment.

Only qualified personnel should service the device or install the device in a vehicle. Faulty installation or service may be dangerous and may invalidate your warranty. Check regularly that all wireless device equipment in your vehicle is mounted and operating properly. Do not store or carry flammable liquids, gases, or explosive materials in the same compartment as the device, its parts, or accessories. Remember that air bags inflate with great force. Do not place your device or accessories in the air bag deployment area.

Switch off your device before boarding an aircraft. The use of wireless teledevices in an aircraft may be dangerous to the operation of the aircraft and may be illegal.

Potentially explosive environments

Switch off your device in any area with a potentially explosive atmosphere. Obey all posted instructions. Sparks in such areas could cause an explosion or fire resulting in bodily injury or death. Switch off the device at refuelling points such as near gas pumps at service stations. Observe restrictions in fuel depots, storage, and distribution areas; chemical plants; or where blasting operations are in progress. Areas with a potentially explosive atmosphere are often, but not always, clearly marked. They include areas where you would be advised to turn off your vehicle engine, below deck on boats, chemical transfer or storage facilities and where the air contains chemicals or particles such as grain, dust, or metal powders. You should check with the manufacturers of vehicles using liquefied petroleum gas (such as propane or butane) to determine if this device can be safely used in their vicinity.

Emergency calls

Important: This device operates using radio signals, wireless networks, landline networks, and user-programmed functions. If your device supports voice calls over the internet (internet calls), activate both the internet calls and the cellular phone. The device may attempt to make emergency calls over both the cellular networks and through your internet call provider if both are activated. Connections in all conditions cannot be guaranteed. You

should never rely solely on any wireless device for essential communications like medical emergencies.

To make an emergency call:

- 1 If the device is not on, switch it on. Check for adequate signal strength. Depending on your device, you may also need to complete the following:
 - Insert a SIM card if your device uses one.
 - Remove certain call restrictions you have activated in your device.
 - Change your profile from Offline or Flight profile to an active profile.
- 2 Press the end key as many times as needed to clear the display and ready the device for calls.
- 3 Enter the official emergency number for your present location. Emergency numbers vary by location.
- 4 Press the call key.

When making an emergency call, give all the necessary information as accurately as possible. Your wireless device may be the only means of communication at the scene of an accident. Do not end the call until given permission to do so.

Certification information (SAR)

This mobile device meets guidelines for exposure to radio waves.

Your mobile device is a radio transmitter and receiver. It is designed not to exceed the limits for exposure to radio waves recommended by international guidelines. These guidelines were developed by the independent scientific organisation ICNIRP and include safety margins designed to assure the protection of all persons, regardless of age and health.

The exposure guidelines for mobile devices employ a unit of measurement known as the Specific Absorption Rate or SAR. The SAR limit stated in the ICNIRP guidelines is 2.0 watts/kilogram (W/kg) averaged over 10 grams of tissue. Tests for SAR are conducted using standard operating positions with the device transmitting at its highest certified power level in all tested frequency bands. The actual SAR level of an operating device can be below the maximum value because the device is designed to use only the power required to reach the network. That amount changes depending on a number of factors such as how close you are to a network base station.

The highest SAR value under the ICNIRP guidelines for use of the device at the ear is 0.89 W/kg.

Use of device accessories may result in different SAR values. SAR values may vary depending on national reporting and testing requirements and the network band. Additional SAR information may be provided under product information at www.nokia.com.

DECLARATION OF CONFORMITY

CE 0434

Hereby, NOKIA CORPORATION declares that this RM-615 product is in compliance with the essential requirements and other relevant provisions of Directive 1999/5/EC. A copy of the Declaration of Conformity can be found at http://www.nokia.com/phones/declaration_of_conformity/.

© 2010 Nokia. All rights reserved.

Nokia, Nokia Connecting People and Navi are trademarks or registered trademarks of Nokia Corporation. Nokia tune is a sound mark of Nokia Corporation. Other product and company names mentioned herein may be trademarks or tradenames of their respective owners.

Portions of the Nokia Maps software are ©1996-2010 The FreeType Project. All rights reserved.

Reproduction, transfer, distribution, or storage of part or all of the contents in this document in any form without the prior written permission of Nokia is prohibited. Nokia operates a policy of continuous development. Nokia reserves the right to make changes and improvements to any of the products described in this document without prior notice.



Includes RSA BSAFE cryptographic or security protocol software from RSA Security.



Java and all Java-based marks are trademarks or registered trademarks of Sun Microsystems, Inc.

This product is licensed under the MPEG-4 Visual Patent Portfolio License (i) for personal and noncommercial use in connection with information which has been encoded in compliance with the MPEG-4 Visual Standard by a consumer engaged in a personal and noncommercial activity and (ii) for use in connection with MPEG-4 video provided by a licensed video provider. No license is granted or shall be implied for any other use. Additional information, including that related to promotional, internal, and commercial uses, may be obtained from MPEG LA, LLC. See <http://www.mpegla.com>.

TO THE MAXIMUM EXTENT PERMITTED BY APPLICABLE LAW, UNDER NO CIRCUMSTANCES SHALL NOKIA OR ANY OF ITS LICENSORS BE RESPONSIBLE FOR ANY LOSS OF DATA OR INCOME OR ANY SPECIAL, INCIDENTAL, CONSEQUENTIAL OR INDIRECT DAMAGES HOWSOEVER CAUSED.

THE CONTENTS OF THIS DOCUMENT ARE PROVIDED "AS IS". EXCEPT AS REQUIRED BY APPLICABLE LAW, NO WARRANTIES OF ANY KIND, EITHER EXPRESS OR IMPLIED, INCLUDING, BUT NOT LIMITED TO, THE IMPLIED WARRANTIES OF MERCHANTABILITY AND FITNESS FOR A PARTICULAR PURPOSE, ARE MADE IN RELATION TO THE ACCURACY, RELIABILITY OR CONTENTS OF THIS DOCUMENT. NOKIA RESERVES THE RIGHT TO REVISE THIS DOCUMENT OR WITHDRAW IT AT ANY TIME WITHOUT PRIOR NOTICE. The availability of particular products and applications and services for these products may vary by region. Please check with your Nokia dealer for details and availability of language options. This device may contain commodities, technology or software subject to export laws and

regulations from the US and other countries. Diversion contrary to law is prohibited.

FCC/INDUSTRY CANADA NOTICE

Your device may cause TV or radio interference (for example, when using a telephone in close proximity to receiving equipment). The FCC or Industry Canada can require you to stop using your telephone if such interference cannot be eliminated. If you require assistance, contact your local service facility. This device complies with part 15 of the FCC rules. Operation is subject to the following two conditions: (1) This device may not cause harmful interference, and (2) this device must accept any interference received, including interference that may cause undesired operation. Any changes or modifications not expressly approved by Nokia could void the user's authority to operate this equipment.

Model number: Nokia 5330-1d

/Issue 2 EN

Index**Symbols/Numbers**

3G	16
----	----

A

access codes	10
alarm clock	52
anykey answer	27
applications	44

B

backing up data	22
battery	6, 7
browser	41
business cards	51

C

cache memory	42
calculator	53
calendar	52
call divert	27
call log	26
call waiting	27
caller id	27
calls	25
camera	34
camera settings	35
configuration	24

contacts	
— groups	51
— saving	50
cookies	42

D

data cable	22
dialling shortcuts	19, 25
digital rights	57
display	12, 18
downloads	55

E

e-mail	33
e-mail, attachments	34
e-mail, creating	34
e-mail, reading and replying to	34
equaliser	41

F

factory settings	56
file management	37
flash messages	30
flight profile	15, 16
font size	19

G

games	44
GPS (global positioning system)	49

H

handsfree	26
headset	9
help application	16
home screen	12, 18

I

IM	31
IM (instant messaging)	31, 32, 33, 34
images	34, 36
in-call timer	27
indicators	12, 13
info messages	23
instant messaging	31
internet	41

K

keyguard	16
keypad lock	15
keys	5

L

language settings	16
lights	18
location information	23
lock switch	15
locking, keypad	15
loudspeaker	26

M

mail	33
mail setup	33
Maps	48, 49
media player	36, 38
memory	37
memory card	6
message centre number	29
message sending	30
message settings	31
messages	30
microSD card	6
Mobile TV	45, 46
— programme guides	46
mobile TV	44, 45, 47
— settings	47
mobile tv	
— program guides	44
— recording programs	44
— settings	44
— watching programs	44
music player	38
My Nokia	54

N

navigation	14
navigation tools	49
Nokia support information	54
notes	53
number mode	27

O

offline mode	15
online sharing	42
operator menu	23

P

parts	5
PC Suite	23
photographs	34
PictBridge	22
PIN code	10
position log	23
predictive text input	28
printing	37
profiles	17
PUK codes	10

R

radio	39, 40
recorder	40
redial	27
restoring data	22

S

screen saver	18
scrolling	14
security code	10
security settings	16
service commands	23
settings	
— mobile TV	47

sharing	42
shortcuts	12, 19
SIM	
— services	23
SIM card	6, 15
SIM messages	23
software update	55
software updates	16, 55
speed dialling	19, 25, 27
stopwatch	53
strap	9
support resources	54
synchronisation	22

T

text modes	27
themes	18
tones	16, 18
touch music keys	13
traditional text input	28
tv	
See <i>mobile tv</i>	

U

updates	55
UPIN code	10
USB data cable	22

V

video	35, 36
voice clarity	27

voice commands	19
voice dialling	25
voice recognition	19
voice recorder	40

W

wallpaper	18
web	41
write text	27