

# Nokia MobileTV Headset DVB-H

---

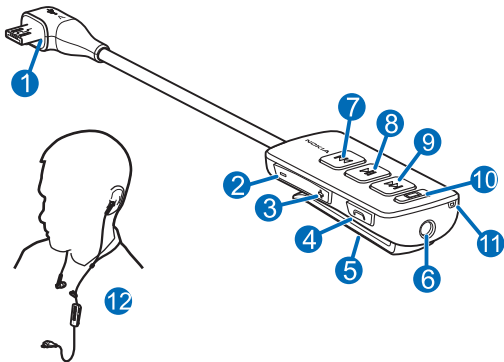



© 2010 Nokia. All rights reserved.

## Introduction

With the Nokia MobileTV Headset DVB-H, you can receive digital TV broadcasts in the Digital Video Broadcasting-Handheld (DVB-H) format, make and answer calls, and listen to music from a compatible device.

To watch TV, you must have a compatible Nokia mobile device with the Nokia Mobile TV application installed. If the application is not already installed in your device, for availability, go to [www.ovi.com](http://www.ovi.com). To use the application, you may need to update the software of your device.

Nokia, Nokia Connecting People and the Nokia Original Accessories logo are trademarks or registered trademarks of Nokia Corporation.

Read this user guide carefully before using the headset. Also read the help of the Nokia Mobile TV application and the user guide for the device to which you connect the headset.

This product may contain small parts. Keep them out of the reach of small children.



**Warning:** The plugs of this device may contain a small amount of nickel. Persons who are sensitised to nickel may have symptoms from prolonged skin contact with the plugs. The surface of this device contains stainless steel.

## Mobile TV services

Mobile TV services may only be available upon subscription. For the mobile TV network coverage, the availability and costs of the services, and instructions on how to access the services, contact your service provider.

If you do not have access to a mobile TV service, make sure you have a valid

subscription to the service and that you are in the coverage area of the service.

In some countries, owners of a television receiver are required to pay a television licence fee. For more information, contact your local authorities.

## Get started

---

The headset contains the following parts shown on the title page: USB plug (1), volume down key (2), volume up key (3), call key (4), clip (5), headphone connector (6), rewind key (7), play/pause key (8), fast-forward key (9), MobileTV key (10), and microphone (11).

The headset can be used with a compatible Nokia mobile device that has a micro USB connector and with

compatible headphones that have a 3.5 mm stereo plug.

The headset supports the USB 2.0 Full Speed standard.



**Warning:** When you use the headset, your ability to hear outside sounds may be

affected. Do not use the headset where it can endanger your safety.

Parts of the device are magnetic. Metallic materials may be attracted to the device.

Do not place credit cards or other magnetic storage media near the device,

because information stored on them may be erased.

## Basic use

---

### Connect headphones

Insert the plug of your headphones into the respective connector, and insert the USB plug of the headset into the USB connector in your mobile device.

For optimal performance, use the headphones supplied with the headset.

### Wear the headset

Place the speaker pads of your headphones on your ears (12).

### Watch TV

Before you start to use the headset to watch TV programs on your compatible Nokia device, make sure

the Nokia Mobile TV application is installed in the device.

The headset uses the headphone cable as an antenna for the built-in TV receiver.

Connect your compatible headphones to the headset.

To open the application on your device, press the MobileTV key. For details on using the application, see the in-device help of the application.

To select the next TV channel, press the fast-forward key. To select the previous channel, press the rewind key.

## Change the volume

To change the headset volume, use the volume keys.

## Calls

To make a call, use your mobile device in the normal way when the headset is connected to your device.

If your mobile device supports voice dialling, press and hold the call key, and proceed as described in the user guide of your device.

To answer or end a call, press the call key. To reject a call, press the call key twice.

## Listen to music

You can use the headset to listen to music on your compatible mobile device.

To play a song, select the song in the music player of your mobile device, and press the play/pause key. For details, see the user guide of your device.

To select the next song, press the fast-forward key. To select the previous song, press the rewind key. To scroll through the songs quickly during playback, press and hold either key.

To pause or restart playback, press the play/pause key.



**Warning:** Listen to a headset at a moderate level.

## Take care of your device

Handle your device and accessories with care. The following suggestions help you protect your warranty coverage.

- Keep the device dry. Precipitation, humidity, and all types of liquids or moisture can contain minerals that corrode electronic circuits. If your device gets wet, allow it to dry completely.
- Do not use or store the device in dusty or dirty areas. Moving parts and electronic components can be damaged.
- Do not store the device in high temperatures. High temperatures can shorten the life of the device and warp or melt plastics.
- Do not store the device in cold temperatures. When the device warms to its normal temperature, moisture can form inside the device and damage electronic circuits.
- Do not attempt to open the device.
- Do not drop, knock, or shake the device. Rough handling can break internal circuit boards and mechanics.
- Only use a soft, clean, dry cloth to clean the surface of the device.
- Do not paint the device. Paint can clog the moving parts and prevent proper operation.

### Recycle

Always return your used electronic products, batteries, and packaging materials to dedicated collection points. This way you help prevent uncontrolled waste disposal and promote the recycling of materials. Check product environmental information and how to recycle your Nokia products at [www.nokia.com/werecycle](http://www.nokia.com/werecycle), or with a mobile device, [www.nokia.mobi/werecycle](http://www.nokia.mobi/werecycle).



The crossed-out wheeled-bin symbol on your product, battery, literature, or packaging reminds you that all electrical and electronic products, batteries,

and accumulators must be taken to separate collection at the end of their working life. This requirement applies in the European Union. Do not dispose of these products as unsorted municipal waste. For more information on the environmental attributes of your device, see [www.nokia.com/ecodeclaration](http://www.nokia.com/ecodeclaration).